

Contract No. CV/2012/09  
 Liantang / Heung Yuen Wai Boundary Control Point  
 Site Formation and Infrastructure Works - Contract 3

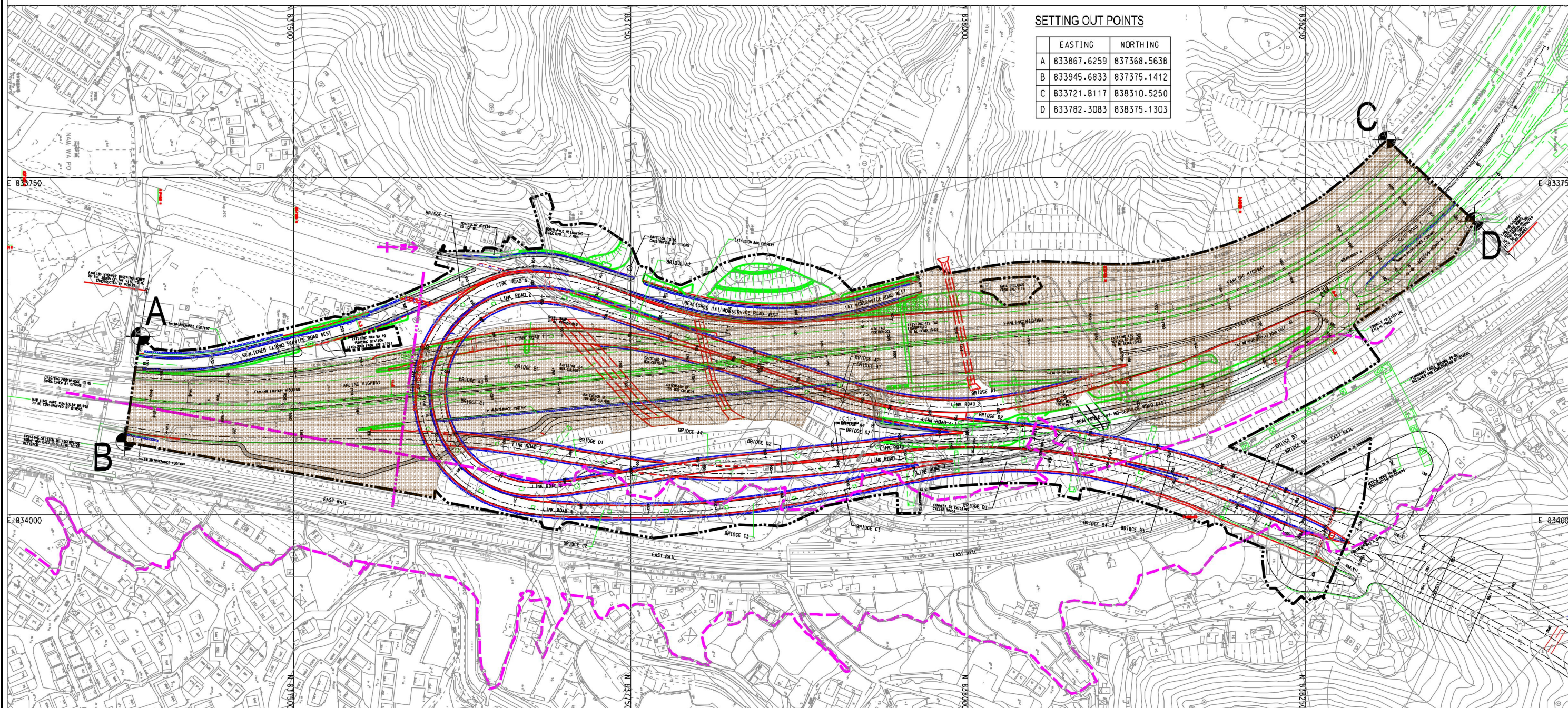

俊和建築工程有限公司  
 CHUN WO CONSTRUCTION & ENGINEERING CO., LTD.



CV/201209-T-CWC-SK-001g\_AD\_edit.dgn 22/1/2014 17:10:34

**Legend:**

 Works Area for Entrusted Portion



Entrusted Portion of Widening of Tolo Highway / Fanling Highway between Island House Interchange and Fanling Stage 2

Figure 1: Demarcation of Entrusted Portion of Widening of Tolo Highway / Fanling Highway between Island House Interchange and Fanling – Stage 2