

CV/201209-T-CWC-SK-001g\_AD\_edit.dgn 22/1/2014 17:10:34

**Legend:**

 Works Area for Entrusted Portion

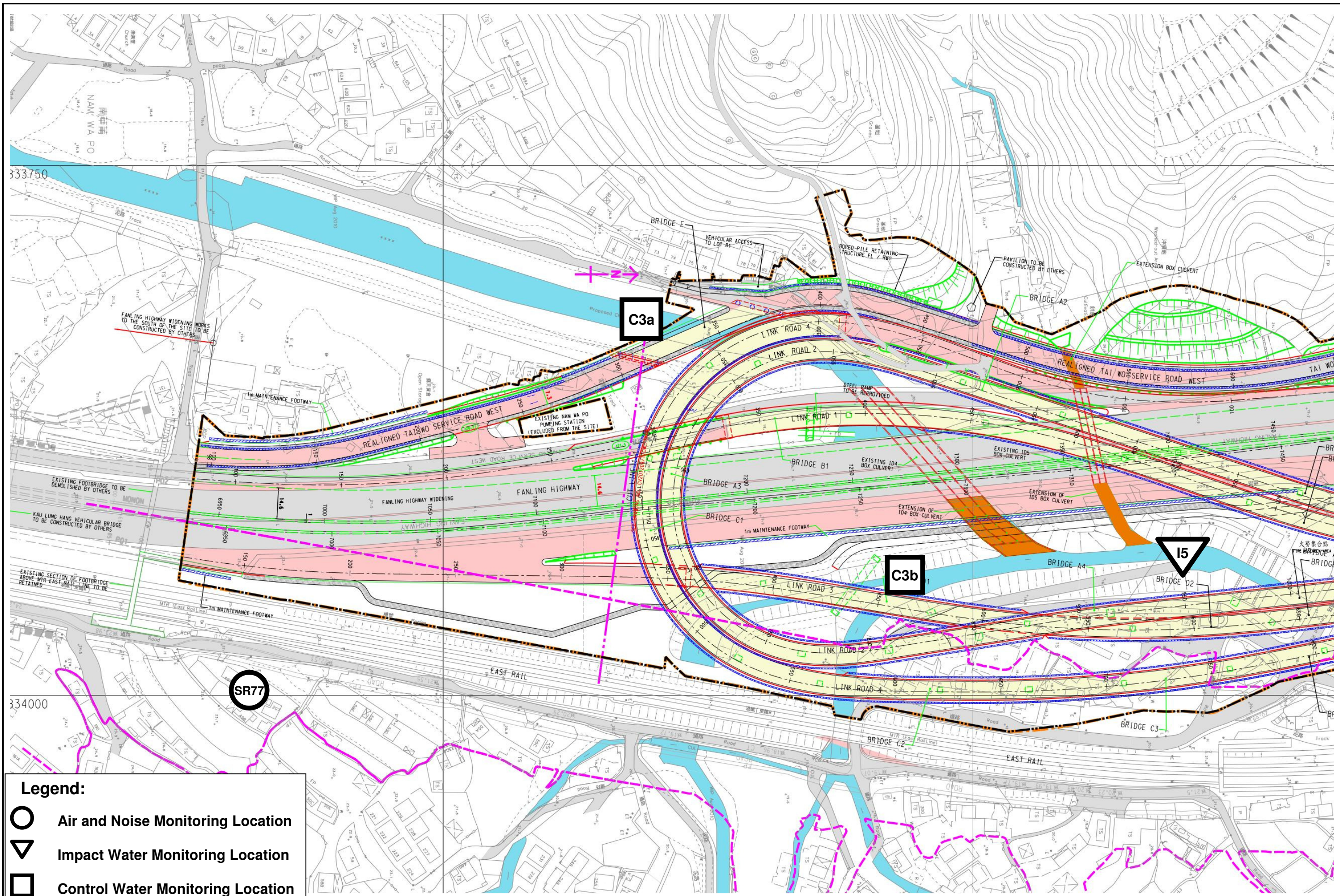

- Legend:**
- Air and Noise Monitoring Location
  - ▽ Impact Water Monitoring Location
  - Control Water Monitoring Location



Entrusted Portion of Widening of Tolo Highway / Fanling Highway between Island House Interchange and Fanling Stage 2

Figure 2: Environmental Monitoring Locations