

CONTRACT NO. HY/2012/06
Widening of Fanling Highway
Between Tai Hang and Wo Hop Shek Interchange (Stage 2)

ENVIRONMENTAL COMPLAINT ACTION FORM

Environmental Enquiry No.: EC-04
(Related Previous Enquiry NO.: --)

COMPLAINT DETAILS

Date Received	31 December 2014
Parameter	* Air / Noise / Water / Waste / Landscape
Enquirer's Details	
Name	Not disclosed
Contact Tel No.	Not disclosed
Address	Not disclosed

FOLLOW-UP ACTION

First Contact with the Complaint by	* Telephone / Site Visit / Referral from EPD (ref. N05/RN/00032184-14)
Date of the First Contact	29 December 2014
<p>Details of Complaint:</p> <p>EPD referred a water complaint on 31 December 2014.</p> <p>The complainant complained about the muddy river outside Tai Hang Village Office on 29 December 2014. It was suspected that the muddy water was discharged from the construction works of the Project.</p> <p>He now requires the EPD to follow up.</p>	
<p>Investigation and Findings :</p> <p>According to the Contractor (China State Construction Engineering (HK) Ltd.), trial pit excavation to expose a double air valve of Dongjiang River water pipeline was carried out on 29 December 2014 at the complained area (Figure 1).</p> <p>Following the receipt of the complaint, the Contractor inspected the concerned site area and stopped the works at once. It was believed that there has been a failure in the Contractor's</p>	

internal communication channel and a wastewater treatment unit had not been deployed at the area before carrying out the works. After the complaint, a review meeting was held on 30 December 2014 to enhance the Contractor's internal communication. They have also evaluated all their coming construction activities in order to ensure there is sufficient and proper wastewater treatment unit available on site to prevent wastewater from being discharged without treatment. All works at the area had been suspended until the installation of a wastewater treatment unit was completed on 2 January 2015 afternoon (Figure 2).

The wastewater treatment unit is in full operation. The machine is operating effectively and effluent is visually clear (Figure 3, taken on 3 January 2015).

The Contractor was reminded to ensure proper wastewater treatment facilities are installed before construction activities will be carried out to prevent the recurrence of water-related complaints.

The complaint is considered project-related.

The Contractor is advised to implement the mitigation measures as stated in "Recommended Mitigation Measures".

Exceedance Associated with Site Activity to	* No Exceedance /-Action / Limit-
---	-----------------------------------

<p>Recommended Mitigation Measures:</p> <ol style="list-style-type: none"> 1) Enhance preventive measures for muddy water discharge; 2) Maintain the frequency of environmental supervision including the visual inspection of the discharge of treated water (by the Contractor) to regularly review the adequacy and effectiveness of muddy water control to suit the construction progress; 3) Foster better public relations with the sensitive receivers and complainants nearby; 4) Maintain properly all wastewater treatment units; and 5) Follow the Discharge License of the Project strictly.

* Delete where inappropriate

MONITORING

Ad hoc Monitoring undertaken	* Yes / No

* Delete where inappropriate

Prepared by: Y W Fung
Designation: Environmental Team Leader
Signature: 
Date: 6 January 2015

Figure 1 - Site Location Plan

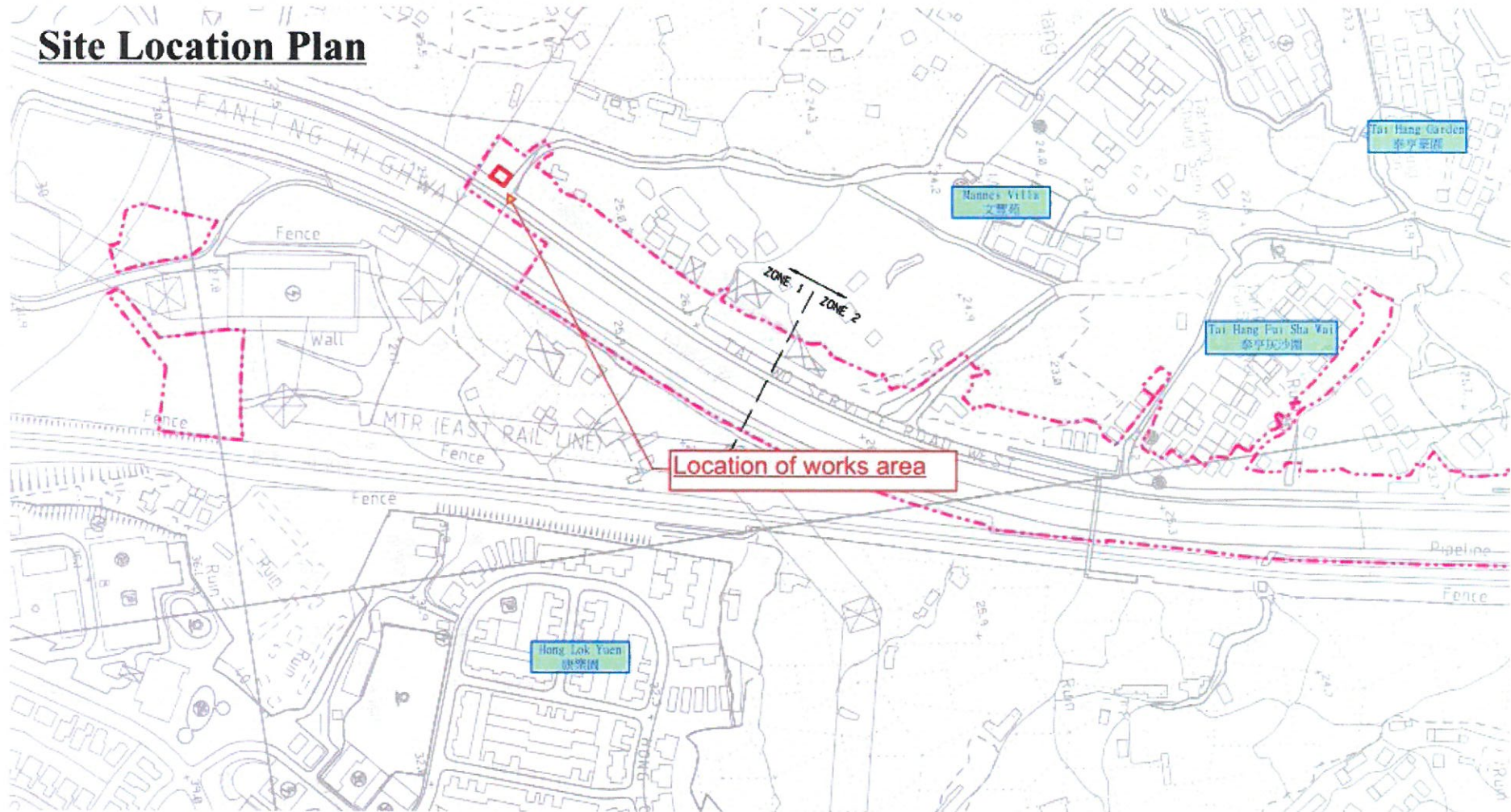

Figure 2 - Installation of the wastewater treatment unit for the complained area



Figure 3 – Photo showing the effluent discharged from the wastewater treatment unit (3 January 2015)

