

Entrusted Portion of Widening of Tolo Highway / Fanling Highway between Island House Interchange and Fanling Stage 2

Monthly EM&A Report

October 2017

Submitted to

Environmental Protection Department

Prepared By

Meinhardt Infrastructure and Environment Ltd

Meinhardt Infrastructure and Environment Limited

**Entrusted Portion of Widening of Tolo
Highway / Fanling Highway between Island
House Interchange and Fanling Stage 2**

Monthly EM&A Report

(October 2017)

Certified by:

Fredrick Leong



Position:

Environmental Team Leader

Date:

9 November 2017

Hyder-Arup-Black & Veatch Joint Venture
c/o Arcadis
20/F, AXA Tower, Landmark East,
100 How Ming Street,
Kwun Tong, Hong Kong
Attn: Mr. James Penny

Your Reference

Our Reference
JFP/EC/ST/pl/T329380/22
.05/L-0189

20/F AIA Kowloon Tower
Landmark East
100 How Ming Street
Kwun Tong
Kowloon
Hong Kong

T +852 2828 5757
F +852 2827 1823
mottmac.hk

Environmental Monitoring and Audit (EM&A) for Widening of Tolo Highway/Fanling Highway between Island House Interchange and Fanling Stage 2 (between Tai Hang to Wo Hop Shek Interchange) – Entrusted Works Environmental Permit No. EP-324/2008/E Condition 3.3 – Submission of Monthly EM&A Report – October 2017 for the portion of Stage 2 works entrusted to Civil Engineering and Development Department (CEDD) under Contract No. CV/2012/09

08 November 2017
By Fax (2805 5028) & Hand

We refer to the revised Monthly EM&A Report – October 2017 received on 07 November 2017 submitted by the Environmental Team via email. Pursuant to Environmental Permit Condition 3.3, I hereby verify the Monthly EM&A Report – October 2017 (Rev. 0) for the portion of works under Stage 2 of the captioned Project which is entrusted to CEDD under Contract No. CV/2012/09.

Yours faithfully
for MOTT MACDONALD HONG KONG LIMITED





Steven Tang
Independent Environmental Checker

c.c.
HyD
CEDD/BCP
AECOM
Meinhardt

Mr. Chung Lok Chin
Mr. Lu Pei Yu
Mr. Alan Lee
Mr. Fredrick Leong

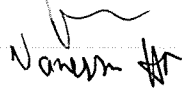
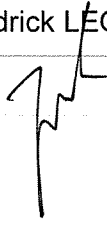
By Fax (2714 5198)
By Fax (3547 1659)
By Fax (3922 9797)
By Fax (2559 1613)

Date	Revision	Prepared By	Checked By	Approved By
9 November 2017	0	WK CHIU Vanessa HO	Fredrick LEONG	Helen COCHRANE
				

Contents

	Page
EXECUTIVE SUMMARY	i
1 INTRODUCTION	1
1.2 Purpose of the Report	1
1.3 Report Structure	1
2 PROJECT INFORMATION	2
2.1 Background	2
2.2 Site Description	3
2.3 Construction Programme and Activities	3
2.4 Project Organisation	3
3 STATUS OF ENVIRONMENTAL LICENSES, NOTIFICATION AND PERMITS	5
4 AIR QUALITY MONITORING	7
4.1 Monitoring Requirement	7
4.2 Monitoring Equipment	7
4.3 Monitoring Location	7
4.4 Monitoring Parameters, Frequency and Duration	7
4.5 Monitoring Methodology	8
4.6 Monitoring Schedule for the Reporting month.....	8
4.7 Monitoring Results.....	8
5 NOISE MONITORING	10
5.1 Monitoring Requirements	10
5.2 Monitoring Equipment	10
5.3 Monitoring Locations	10
5.4 Monitoring Parameters, Frequency and Duration	10
5.5 Monitoring Methodology	11
5.6 Monitoring Schedule for the Reporting Month.....	11
5.7 Monitoring Results.....	11
6 WATER MONITORING	13
7 WASTE MANAGEMENT	14
8 ENVIRONMENTAL SITE INSPECTION AND AUDIT	15
8.1 Site Inspection.....	15
9 IMPLEMENTATION STATUS OF ENVIRONMENTAL MITIGATION MEASURES	16
10 SUMMARY OF EP SUBMISSION IN THE REPORTING MONTH	17
11 ENVIRONMENTAL NON-CONFORMANCE	18
11.1 Summary of Monitoring Exceedances	18

11.2	Summary of Environmental Non-Compliance	18
11.3	Summary of Environmental Complaints.....	18
11.4	Summary of Environmental Summon and Successful Prosecutions.....	18
12	FUTURE KEY ISSUES	19
12.1	Construction Programme for the Next Month.....	19
12.2	Key Issues for the Coming Month.....	19
12.3	Monitoring Schedule for the Next Month.....	20
13	CONCLUSIONS AND RECOMMENDATIONS	21
13.1	Conclusions.....	21
13.2	Recommendations	21

List of Tables

Table 2.1	Contact Information of Key Personnel
Table 3.1	Status of Environmental Licenses, Notifications and Permits
Table 4.1	Air Quality Monitoring Equipment
Table 4.2	Location of Air Quality Monitoring
Table 4.3	Air Quality Monitoring Parameters, Frequency and Duration
Table 4.4	Summary of 1-hr TSP Monitoring Results
Table 4.5	Summary of 24-hr TSP Monitoring Results
Table 5.1	Noise Monitoring Equipment
Table 5.2	Location of Noise Monitoring
Table 5.3	Noise Monitoring Parameters, Frequency and Duration
Table 5.4	Summary of Noise Monitoring Results
Table 8.1	Observations and Recommendations of Site Audit
Table 10.1	Status of Required Submission under Environmental Permit

List of Figures

Figure 1	Demarcation of Entrusted Portion of Widening of Tolo Highway / Fanling Highway between Island House Interchange and Fanling – Stage 2
Figure 2	Air and Noise Monitoring Locations

List of Appendices

Appendix A	Construction Programme
Appendix B	Project Organization Structure
Appendix C	Calibration Certificates of Monitoring Equipment
Appendix D	EM&A Monitoring Schedules
Appendix E	Meteorological Data Extracted from Hong Kong Observatory
Appendix F	Air Quality Monitoring Results and their Graphical Presentation
Appendix G	Summary of Event and Action Plan
Appendix H	Noise Monitoring Results and their Graphical Presentation
Appendix I	Not Used
Appendix J	Not Used
Appendix K	Waste Flow Table
Appendix L	Implementation Schedule of Environmental Mitigation Measures (EMIS)
Appendix M	Not Used
Appendix N	Statistics on Complaints, Notifications of Summons and Successful Prosecutions

EXECUTIVE SUMMARY

The Entrusted Portion of Widening of Tolo Highway / Fanling Highway between Island House Interchange and Fanling Stage 2 (hereafter called “the Project”) covers part of the construction of the widening of Tolo Highway / Fanling Highway between Island House Interchange and Fanling which aimed to widen Tolo Highway and Fanling Highway to dual 4-lane carriageway in order to alleviate the current traffic congestion problems and to cope with the increasing transport demands to and from the urban areas and also cross boundary traffic. The Project covers construction activities at Yuen Leng along the existing Fanling Highway.

The impact EM&A for the Project includes air quality, noise and water quality monitoring. The EM&A programme commenced on 5 November 2013.

This report documents the findings of EM&A works conducted in October 2017. As informed by the Contractor, the major activities in the reporting month were:

- Cable detection and trial trenches;
- Remaining works on new Footbridge;
- Noise barrier construction;
- Roadworks;
- Viaduct segment erection;
- Water main laying works;
- Installation of Noise barrier steel column & panel;
- Parapet Installation on bridge deck;
- Drainage Work;
- Mini-pile installation;
- Construction of profile barrier & Planter wall on Bridge deck;
- Stressing of external tendon; and
- Construction of retaining wall behind abutment.

Breach of Action and Limit Levels for Air Quality

No exceedance of Action and Limit Level was recorded for 24-hour TSP monitoring at the monitoring location AM1(SR77) in the reporting month.

No exceedance of Action and Limit Level was recorded for 1-hour TSP monitoring at the monitoring location AM1(SR77) in the reporting month.

Breach of Action and Limit Levels for Noise

No noise complaint was received in the reporting month, so no Action Level exceedance was recorded. Also, no Limit Level exceedance of noise monitoring was recorded in the reporting month.

Breach of Action and Limit Levels for Water Quality

The box culvert works have been completed in the end of March 2017. The 4-week post construction water quality monitoring has been completed in the end of April 2017 in the same manner as the impact monitoring.

Complaint, Notification of Summons and Successful Prosecution

No complaint, notification of summons and successful prosecution was received in the reporting month.

Future Key Issues

The major construction works in the coming reporting month are anticipated to include:

- Boundary wall for pumping station;
- Cable detection and trial trenches;
- Installation of noise barrier steel post & panel;
- Remaining works on new Footbridge;
- Mini-pile installation works;
- Noise barrier construction;
- Roadworks;
- Viaduct Segment erection;
- Water main laying works;
- Parapet Installation on bridge deck;
- Construction of profile barrier & Planter wall on Bridge deck;
- Drainage Work;
- Stressing of external tendon;
- Construction of retaining wall behind abutment; and
- Installation of Sign Gantry.

Potential environmental impacts arising from the above construction activities are anticipated to be mainly associated with construction dust, noise, water quality and waste management.

1 INTRODUCTION

1.1.1 Chun Wo Construction & Engineering Co Ltd (Chun Wo) was commissioned by the Civil Engineering and Development Department (CEDD) as the Civil Contractor for the Entrusted Portion of Widening of Tolo Highway / Fanling Highway between Island House Interchange and Fanling Stage 2. Meinhardt Infrastructure & Environment Ltd (MIEL) has been appointed by Chun Wo as the Environmental Team (ET) to fulfill the corresponding EM&A requirements pursuant to Environmental Permit No. EP-324/2008/E in accordance with the Updated EM&A Manual (dated October 2013) for Widening of Tolo Highway/Fanling Highway between Island House Interchange and Fanling Stage 2. The EM&A programme commenced on 5 November 2013.

1.2 Purpose of the Report

1.2.1 This is the monthly EM&A Report which summaries the impact monitoring results and audit findings for the Project during the reporting month of October 2017.

1.3 Report Structure

1.3.1 This monthly EM&A Report comprises the following sections:

Section 1: Introduction

Section 2: Project Information

Section 3: Status of Environmental Licenses, Notifications and Permits

Section 4: Air Quality Monitoring

Section 5: Noise Monitoring

Section 6: Water Monitoring

Section 7: Waste Management

Section 8: Environmental Site Inspection and Audit

Section 9: Implementation Status of Environmental Mitigation Measures

Section 10: Summary of EP Submission in the Reporting Month

Section 11: Environmental Non-Conformance

Section 12: Future Key Issues

Section 13: Conclusions and Recommendations

2 PROJECT INFORMATION

2.1 Background

- 2.1.1 Tolo Highway and Fanling Highway are expressways in the North East New Territories connecting Sha Tin, Tai Po and Fanling. These highways form a vital part of the strategic Route 1, which links Hong Kong Island to Shenzhen. At present, this section of Route 1 is a dual 3-lane carriageway. However, at several major interchanges along this section of Route 1, the highway is only dual-2 lane. Severe congestion is a frequent occurrence during peak periods, particularly in the Kowloon bound direction.
- 2.1.2 The objective of the Widening of Tolo Highway / Fanling Highway between Island House Interchange and Fanling is to widen Tolo Highway and Fanling Highway to dual 4-lane carriageway in order to alleviate the current traffic congestion problems and to cope with the increasing transport demands to and from the urban areas and also cross boundary traffic.
- 2.1.3 The construction works for the Widening of Tolo Highway / Fanling Highway between Island House Interchange and Fanling are to be delivered in 2 stages:
- Stage 1 – Construction works between Island House Interchange and Tai Hang; and
- Stage 2 – Construction works between Tai Hang and Wo Hop Shek Interchange.
- 2.1.4 The construction works of Stage 1 under the EP commenced in November 2009 and was planned to be completed in December 2013 tentatively. The works of Stage 2 was planned to commence in November 2013 and complete by end of 2016. Hyder-Arup-Black and Veatch Joint Venture (HABVJV) was appointed by the Highways Department (HyD) as the consultants for the design and construction assignment for the Project. Mott MacDonald Hong Kong Ltd is the Independent Environmental Checker (IEC) of both Stage 1 and Stage 2 works.
- 2.1.5 A portion of Stage 2 works of Widening of Tolo Highway / Fanling Highway between Island House Interchange and Fanling (hereafter called “the Project”) is entrusted to the contractor of Contract No. CV/2012/09 Liantang / Heung Yuen Wai Boundary Control Point Site Formation and Infrastructure Works Contract 3, i.e. Chun Wo. AECOM Asia Co Ltd was appointed by the CEDD as the consultant for the design and construction assignment for the Liantang development.
- 2.1.6 The Project is a Designated Project under the Environmental Impact Assessment Ordinance (EIAO) (Cap. 499). An Environmental Impact Assessment (EIA) Report together with an Environmental Monitoring and Audit (EM&A) Manual were approved on 14 July 2000 (Register Number: EIA-043/2000). The Project is governed by an Environmental Permit (EP) (EP-324/2008) which was granted on 23 December 2008. A variation of EP (VEP) was applied and the VEP (EP-324/2008/A) was subsequently granted on 31 January 2012. An additional VEP has been applied on 24 February 2014 and the VEP (EP-324/2008/B) was subsequently granted on 17 March 2014. Furthermore, an additional VEP has been applied on 9 March 2015 and the VEP (EP-324/2008/C) was subsequently granted on 27 March 2015. The previous VEP (EP-324/2008/D) was granted on 27 August 2015. The current VEP (EP-324/2008/E) was granted on 26 January 2017.

2.2 Site Description

2.2.1 The major construction activities under the Entrusted Portion of Widening of Tolo Highway / Fanling Highway between Island House Interchange and Fanling Stage 2 include:

At-Grade Road Works – Temporary and permanent road formation, pipe laying, road drainage, footpath and noise barrier construction;

Demolition of existing Kiu Tau Footbridge and Footbridge Re-provision; and

Box Culvert Extension – Flow diversion of existing stream, excavation, sub-base and blinding, base, wall and top slab construction.

2.2.2 **Figure 1** shows the works areas for the Entrusted Portion of Widening of Tolo Highway / Fanling Highway between Island House Interchange and Fanling Stage 2.

2.3 Construction Programme and Activities

2.3.1 The major construction activities undertaken in the reporting month are summarized below:

- Cable detection and trial trenches;
- Remaining works on new Footbridge;
- Noise barrier construction;
- Roadworks;
- Viaduct segment erection;
- Water main laying works;
- Installation of Noise barrier steel column & panel
- Parapet Installation on bridge deck;
- Drainage Work;
- Mini-pile installation;
- Construction of profile barrier & Planter wall on Bridge deck;
- Stressing of external tendon; and
- Construction of retaining wall behind abutment.

2.3.2 The construction programme is presented in **Appendix A**.

2.4 Project Organisation

2.4.1 The project organization structure is shown in **Appendix B**. The key personnel contact names and numbers for the Project are summarised in **Table 2.1**.

Table 2.1 Contact Information of Key Personnel

Party	Role	Position	Name	Telephone	Fax
AECOM	Engineer's Representative	Senior Resident Engineer	Mr. Alan Lee	2171 3303	2171 3498
		Resident Engineer (Environmental)	Mr. Perry Yam	2171 3350	
Mott MacDonald	Independent Environmental Checker (IEC)	IEC	Mr. Steven Tang	2828 5920	2827 1823
Chun Wo	Contractor	Site Agent	Mr. Daniel Ho	2638 6144	2638 7077
		Environmental Officer	Ms. Tiffany Tsang	2638 6150	
Meinhardt	Environmental Team (ET)	ET Leader	Mr. Fredrick Leong	2859 1739	2540 1580

3 STATUS OF ENVIRONMENTAL LICENSES, NOTIFICATION AND PERMITS

3.1.1 The relevant environmental licenses, permits and/or notifications on environmental protection for this Project and valid in the reporting month are summarized in **Table 3.1**.

Table 3.1 Status of Environmental Licenses, Notifications and Permits

Permit / License No. / Notification / Reference No.	Valid Period		Status	Remarks
	From	To		
Environmental Permit				
EP-324/2008/E	26 Jan 2017	--	Granted on 26 Jan 2017	
Construction Noise Permit				
GW-RN0235-17	11 Apr 2017	7 Oct 2017	Valid	For installation of parapet at AC5 to AC6
GW-RN0303-17	11 May 2017	10 Oct 2017	Valid	For segment erection crossing over MTRC's Rail Track of Pier AB11 and AD12 (0155-0500)
GW-RN0342-17	28 May 2017	20 Nov 2017	Valid	For road marking works in Fanling Highway bothbounds
GW-RN0376-17	22 Jun 2017	21 Dec 2017	Valid	For dismantling of catch fence within MTR Protection Zone at Tong Hang Tung Chuen
GW-RN0417-17	20 Jun 2017	16 Dec 2017	Valid	For road diversion and maintenance of Fanling Highway Bothbound
GW-RN0458-17	16 Jul 2017	18 Dec 2017	Valid	For lane shifting work of Fanling Highway bothbound
GW-RN0477-17	28 Jul 2017	5 Jan 2018	Valid	For loading and unloading along Fanling Highway both bounds
GW-RN0500-17	29 Aug 2017	24 Feb 2018	Valid	For concreting of stitch construction between AD12 and pier AB11R
GW-RN0501-17	25 Aug 2017	24 Feb 2018	Valid	For general works at the northward of site office

Permit / License No. / Notification / Reference No.	Valid Period		Status	Remarks
	From	To		
GW-RN0508-17	16 Aug 2017	15 Feb 2018	Valid	For fuel delivery and tractor with trailer entering the construction site next to MTRC's East Rail Line at Tong Hang Tung
GW-RN0510-17	10 Aug 2017	18 Nov 2017	Valid	For segment erection, stitches concreting and installation of parapet crossing over Fanling Highway and MTRC's East Rail Line
GW-RN0549-17	6 Sep 2017	5 Mar 2018	Valid	For general works at the southward of site office
GW-RN0567-17	10 Sep 2017	21 Feb 2018	Valid	For segment erection and traverse stitch joints over Fanling Highway and MTRC's East Rail Line
GW-RN0571-17	30 Sep 2017	29 Mar 2018	Valid	For operating water pumping in jacking pit on Tai Wo Service Road West
GW-RN0669-17	25 Oct 2017	7 Apr 2018	Valid	For installation of parapet at AC5 to AC6
Wastewater Discharge License				
WT00016832-2013	28 Aug 2013	31 Aug 2018	Valid	--
Chemical Waste Producer Registration				
5113-634-C3817-01	7 Oct 2013	--	Valid	--
Billing Account for Construction Waste Disposal				
7017914	2 Aug 2013	--	Account Active	--
Notification Under Air Pollution Control (Construction Dust) Regulation				
--	31 Jul 2013	30 Jul 2019	Notified	--

4 AIR QUALITY MONITORING

4.1 Monitoring Requirement

4.1.1 In accordance with the Updated EM&A Manual, 1-hr and 24-hr total suspended particulate (TSP) levels at the designated air quality monitoring station are required. Impact 24-hour TSP monitoring should be carried out for at least once every 6 days. For the 1-hr TSP impact monitoring, the sampling frequency of at least three times in every 6 days should be undertaken when the highest dust impact occurs.

4.2 Monitoring Equipment

4.2.1 The 1hr- TSP and 24-hr TSP air quality monitoring were performed using a High Volume Sampler (HVS), of which its location and operation satisfy, as far as practicable, all the requirements as specified in the Updated EM&A Manual. The brand and model of the equipment are given in **Table 4.1**.

Table 4.1 Air Quality Monitoring Equipment

Equipment	Brand and Model	Quantity	Serial Number
High Volume Sampler (1-hr TSP and 24-hr TSP)	Tisch Total Suspended Particulate Mass Flow Controlled High Volume Air Sampler (Model No. TE-5170 MFC)	1	2359

4.2.2 The HVS and its accessories were maintained in good working condition, such as replacing motor brushes routinely and checking electrical wiring to ensure a continuous power supply.

4.2.3 Calibration of the HVS (five point calibration) using Calibration Kit was carried out every two months. The HVS calibration orifice will be calibrated annually. Calibration certificate of the TE-5025A Calibration Kit and the HVS are provided in **Appendix C**.

4.3 Monitoring Location

4.3.1 Air quality monitoring was conducted at the location specified in the Updated EM&A Manual. **Table 4.2** describes the details of the air quality monitoring station with its location as shown in **Figure 2**.

Table 4.2 Location of Air Quality Monitoring

Air Monitoring Station ID	Monitoring Location	Description
AM1(SR77) *	Yuen Leng 2 *	Residential, Ground floor

Remark:

* Location and Station / ASR ID as identified in Updated EM&A Manual / EIA Report for Widening of Tolo Highway/Fanling Highway between Island House Interchange and Fanling

4.4 Monitoring Parameters, Frequency and Duration

4.4.1 **Table 4.3** summarizes the monitoring parameters, frequency and duration of impact TSP monitoring.

Table 4.3 Air Quality Monitoring Parameters, Frequency and Duration

Parameter	Frequency and Duration
1-hour TSP	At least three times in every 6 days should be undertaken when the highest dust impact occur
24-hour TSP	Once every 6 days

4.5 Monitoring Methodology

1-hr and 24-hr TSP Monitoring

- 4.5.1 With the consideration of criteria stated in the Updated EM&A Manual, the HVS was installed in the vicinity of the air sensitive receivers.
- 4.5.2 The relevant data including temperature, pressure, weather conditions, elapsed-time meter reading for the start and stop of the sampler, identification and weight of the filter paper, and any special phenomena observed were recorded. The weather information was referenced from Hong Kong Observatory (<http://www.weather.gov.hk/wxinfo/pastwx/extractc.htm>).
- 4.5.3 A HOKLAS accredited laboratory with constant temperature and humidity control, and equipped with necessary measuring and conditioning instruments, to handle the 24-hr TSP samples, was employed for sample analysis.
- 4.5.4 Filter papers of size 8"x10" were labelled before sampling. They were inspected to be clean with no pin holes and conditioned in a humidity controlled chamber for over 24-hr and were pre-weighed before use for the sampling.
- 4.5.5 The 24-hr TSP levels were measured by following the standard high volume sampling method for TSP as set out in the Title 40 of the United States Code of Federal Regulations, Chapter 1 (Part 50), Appendix B. TSP was sampled by drawing air through a conditioned, pre-weighed filter paper inside the HVS at a controlled air flow rate. After 24-hr sampling, the filter papers loaded with dust were kept in a clean and tightly sealed plastic bag, and then returned to the laboratory for reconditioning in the humidity controlled chamber followed by accurate weighing by an electronic balance with a readout down to 0.1 mg.
- 4.5.6 All the collected samples were kept in a good condition for 6 months before disposal.
- 4.5.7 For 1-hr TSP monitoring, monitoring methodology is the same as 24-hr TSP monitoring which has been presented in **Section 4.5.1** to **Section 4.5.6**, but with sampling period changed to 1 hour.

4.6 Monitoring Schedule for the Reporting month

- 4.6.1 The schedule for environmental monitoring for the reporting month is provided in **Appendix D**. Meteorological data extracted from Hong Kong Observatory for the reporting month is provided in **Appendix E**.

4.7 Monitoring Results

- 4.7.1 The monitoring results for 1-hr and 24-hr TSP are summarised in **Table 4.4** and **Table 4.5** respectively. Detailed air quality monitoring results and the graphical presentation

of air quality monitoring data for the current and past three reporting months are presented in **Appendix F**.

Table 4.4 Summary of 1-hr TSP Monitoring Results

ASR ID	Average ($\mu\text{g}/\text{m}^3$)	Range ($\mu\text{g}/\text{m}^3$)	Action Level ($\mu\text{g}/\text{m}^3$)	Limit Level ($\mu\text{g}/\text{m}^3$)
AM1(SR77) *	162.2	94.6 – 235.4	292.7	500

Remark:

* Station / ASR ID as identified in Updated EM&A Manual / EIA Report for Widening of Tolo Highway/Fanling Highway between Island House Interchange and Fanling

Table 4.5 Summary of 24-hr TSP Monitoring Results

ASR ID	Average ($\mu\text{g}/\text{m}^3$)	Range ($\mu\text{g}/\text{m}^3$)	Action Level ($\mu\text{g}/\text{m}^3$)	Limit Level ($\mu\text{g}/\text{m}^3$)
AM1(SR77) *	87.9	53.6 – 138.4	170.3	260

Remark:

* Station / ASR ID as identified in Updated EM&A Manual / EIA Report for Widening of Tolo Highway/Fanling Highway between Island House Interchange and Fanling

- 4.7.2 No exceedance of Action and Limit Level was recorded for 24-hour TSP monitoring at the monitoring location AM1(SR77) in the reporting month.
- 4.7.3 No exceedance of Action and Limit Level was recorded for 1-hour TSP monitoring at the monitoring location AM1(SR77) in the reporting month.
- 4.7.4 The Event and Action Plan for the occurrence of non-compliance of the air quality criteria is annexed in **Appendix G**.

5 NOISE MONITORING

5.1 Monitoring Requirements

5.1.1 In accordance with the Updated EM&A Manual, the impact noise monitoring frequency shall depend on the scale of the construction activities. An initial guide on the regular monitoring frequency should be at least once per week when noise generating activities are underway.

5.2 Monitoring Equipment

5.2.1 Noise monitoring was performed using a sound level meter at the monitoring station. The sound level meter deployed complies with the International Electrotechnical Commission Publications 651:1979 (Type 1) and 804:1985 (Type 1) specifications. An acoustic calibrator was deployed to check the sound level meter at a known sound pressure level. The brand and model of the equipment is given in **Table 5.1**.

Table 5.1 Noise Monitoring Equipment

Equipment	Brand and Model	Quantity	Serial Number
Sound Level Calibrator	Rion (Model No. NC-74)	1	34857296
Sound Level Meter	Rion (Model No. NL-52)	1	00821072

5.2.2 The sound level calibrator and sound level meter were verified by a certified laboratory every year. Calibration certificates of the sound level meter and acoustic calibrator are provided in **Appendix C**.

5.3 Monitoring Locations

5.3.1 Impact noise monitoring was conducted at the location specified in the Updated EM&A Manual. **Table 5.2** describes the details of the noise monitoring station with its location as shown in **Figure 2**.

Table 5.2 Location of Noise Monitoring

NSR ID	Monitoring Location	Description
M1(SR77) *	Yuen Leng 2 *	Residential, Ground floor

Remark:

* Location and Station / NSR ID as identified in Updated EM&A Manual / EIA Report for Widening of Tolo Highway/Fanling Highway between Island House Interchange and Fanling

5.4 Monitoring Parameters, Frequency and Duration

5.4.1 **Table 5.3** summarizes the monitoring parameters, frequency and duration of impact noise monitoring.

Table 5.3 Noise Monitoring Parameters, Frequency and Duration

Parameter and Duration	Frequency
30-mins measurement at between 0700 and 1900 on normal weekdays. Leq, L10 and L90 would be recorded.	At least once per week

5.5 Monitoring Methodology

5.5.1 The monitoring procedures are summarised as follows:

- The sound level meter was set on a tripod at a height of 1.2 m above the ground for free-field measurements at monitoring station SR77;
- The battery condition was checked to ensure good functioning of the meter;
- Parameters such as frequency weighting, the time weighting and the measurement time were set as follows:
 - Frequency weighting: A
 - Time weighting: Fast
 - Parameters: Leq, L10 and L90
 - Time measurement: Leq(30-minutes) during non-restricted hours i.e. 07:00 – 19:00 hrs on normal weekdays
- Prior to and after each noise measurement, the meter was calibrated using the acoustic calibrator for 94dB(A) at 1000 Hz. If the difference in the calibration level before and after measurement was more than 1dB(A), the measurement would be considered invalid and repeat of noise measurement would be required after re-calibration or repair of the equipment.
- At the end of the monitoring period, the Leq, L10 and L90 were recorded. In addition, site conditions and noise sources were recorded on a standard record sheet.
- A façade correction of +3dB (A) shall be made to the noise parameter obtained by free field measurement.

5.6 Monitoring Schedule for the Reporting Month

5.6.1 The schedule for environmental monitoring for the reporting month is provided in **Appendix D**. Meteorological data extracted from Hong Kong Observatory for the reporting month is provided in **Appendix E**.

5.7 Monitoring Results

5.7.1 The monitoring results for noise are summarized in **Table 5.4** and the monitoring results and the graphical presentation of noise level for the current and past three reporting months are presented in **Appendix H**.

Table 5.4 Summary of Noise Monitoring Results

Noise Monitoring Station ID	Average, dB(A), Leq (30min) ⁽²⁾	Range, dB(A), Leq (30min) ⁽²⁾	Action Level	Limit Level, dB(A)
M1(SR77) ⁽¹⁾	72.9	70.5 – 74.0	When one documented valid complaint is received	75

Remark:

(1) Station / NSR ID as identified in Updated EM&A Manual / EIA Report for Widening of Tolo Highway/Fanling Highway between Island House Interchange and Fanling

(2) +3dB(A) façade correction included

- 5.7.2 Major noise sources during the noise monitoring included construction activities of the Project and that along Tai Wo Service Road East, and nearby traffic noise.
- 5.7.3 No noise complaint was received in the reporting month, so no Action Level exceedance was recorded. Also, no Limit Level exceedance of noise monitoring was recorded in the reporting month.
- 5.7.4 The Event and Action Plan for the occurrence of non-compliance of the noise criteria is annexed in **Appendix G**.

6 WATER MONITORING

- 6.1.1 The box culvert works had been completed in March 2017. The 4-week post-construction water quality monitoring at I5 was completed in 28 April 2017.

7 WASTE MANAGEMENT

- 7.1.1 The Contractor has registered as a chemical waste producer of the Project. The C&D materials and waste sorting were carried out on-site. Receptacles were provided for general refuse collection.
- 7.1.2 As advised by the Contractor, a total of 2,156m³ of excavated material has been generated. 1,372m³ of inert C&D materials was disposed of at public fill to Tuen Mun Area 38. 240m³ inert C&D materials were reused on site. 90m³ of general refuse was disposed of at North East New Territories (NENT) Landfill. No plastic was collected by recycling contractor in the reporting month. No paper/cardboard packaging was collected by recycling contractor in the reporting month. No metal was collected by recycling contractor in the reporting month. No chemical waste was collected by licensed contractor in the reporting period. Details of the waste management data are presented in **Appendix K**.

8 ENVIRONMENTAL SITE INSPECTION AND AUDIT

8.1 Site Inspection

8.1.1 Site inspections were carried out on a weekly basis to monitor the implementation of proper environmental pollution control and mitigation measures for the Project. A summary of the site inspection is provided in **Appendix L**.

8.1.2 In the reporting month, 4 site inspections were carried out on 3, 12, 18 and 26 October 2017. The one held on 26 October 2017 was a joint inspection with the IEC, ER, ET and Contractor. No site inspection was conducted by the EPD during the reporting month. No non-compliance was recorded during the site inspection. A summary of the reminders and observations recorded during the site inspections are presented in **Table 8.1**.

Table 8.1 Observations and Recommendations of Site Audit

Parameters	Date	Observations and Recommendations	Follow-up
Air Quality	N/A	N/A	N/A
Noise	N/A	N/A	N/A
Water Quality	N/A	N/A	N/A
Waste / Chemical Managem- ent	18 Oct 2017	Reminder: Remove debris regularly at 佐記沙 倉.	Debris has been removed on 18 October 2017. (Item closed)
	26 Oct 2017	Reminder: Housekeeping near noise barrier (NB66) is reminded to enhance and refuse shall be collected and cleared.	The follow up action will be reviewed in the next monthly EM&A Report.
Landscape & Visual	N/A	N/A	N/A
Permits / Licenses	N/A	N/A	N/A

9 IMPLEMENTATION STATUS OF ENVIRONMENTAL MITIGATION MEASURES

- 9.1.1 The Contractor has implemented the relevant environmental mitigation measures as specified in the EIA Reports, EPs and updated EM&A Manual. The implementation status of environmental mitigation measures during the reporting period is summarized in **Appendix L**.

10 SUMMARY OF EP SUBMISSION IN THE REPORTING MONTH

10.1.1 The status of the required submission under the EP during the reporting period is summarized in **Table 10.1**.

Table 10.1 Status of Required Submission under Environmental Permit

EP Condition	Submission	Submission Date
Condition 3.3	Monthly EM&A Report for September 2017	11 October 2017

11 ENVIRONMENTAL NON-CONFORMANCE

11.1 Summary of Monitoring Exceedances

- 11.1.1 No exceedance of Action and Limit Level was recorded for 24-hour TSP monitoring at the monitoring location AM1(SR77) in the reporting month.
- 11.1.2 No exceedance of Action and Limit Level was recorded for 1-hour TSP monitoring at the monitoring location AM1(SR77) in the reporting month.
- 11.1.3 No noise complaint was received in the reporting month, so no Action Level exceedance was recorded. Also, no Limit Level exceedance of noise monitoring was recorded in the reporting month.
- 11.1.4 The 4-week post-construction water quality monitoring at I5 was completed in April 2017.

11.2 Summary of Environmental Non-Compliance

- 11.2.1 No environmental non-compliance was recorded in the reporting month. The cumulative statistics are provided in **Appendix N**.

11.3 Summary of Environmental Complaints

- 11.3.1 No environmental complaints were received in the reporting month. The cumulative statistics are provided in **Appendix N**.

11.4 Summary of Environmental Summon and Successful Prosecutions

- 11.4.1 No environmental related prosecution or notification of summons was received in the reporting month. The cumulative statistics are provided in **Appendix N**.

12 FUTURE KEY ISSUES

12.1 Construction Programme for the Next Month

12.1.1 The major construction works in the coming reporting month are anticipated to include:

- Boundary wall for pumping station;
- Cable detection and trial trenches;
- Installation of noise barrier steel post & panel;
- Remaining works on new Footbridge;
- Mini-pile installation works;
- Noise barrier construction;
- Roadworks;
- Viaduct Segment erection;
- Water main laying works;
- Parapet Installation on bridge deck;
- Construction of profile barrier & Planter wall on Bridge deck;
- Drainage Work;
- Stressing of external tendon;
- Construction of retaining wall behind abutment; and
- Installation of Sign Gantry.

12.2 Key Issues for the Coming Month

12.2.1 Key issues to be considered in the coming month are anticipated to include:

- Site discharges should be properly collected and treated prior to discharge at noise barrier 69;
- Properly maintain all drainage facilities and wheel washing facilities on site;
- Expose slopes and dusty stockpile should be covered up properly if no work will be conducted;
- Good housekeeping should be maintained and general refuse should be removed regularly;
- Chemical waste should be stored, handled and disposed of properly;
- Properly store and label oils and chemicals on site; and
- A spill response procedure shall be in place and absorption material available for minor spillages.

12.3 Monitoring Schedule for the Next Month

- 12.3.1 The tentative schedule for environmental monitoring for the coming month is provided in **Appendix D**.

13 CONCLUSIONS AND RECOMMENDATIONS

13.1 Conclusions

- 13.1.1 The construction phase EM&A programme of the Project commenced on 5 November 2013.
- 13.1.2 The 1-hr TSP, 24-hr TSP, noise and water quality monitoring were carried out in the reporting period.
- 13.1.3 No exceedance of Action and Limit Level was recorded for 24-hour TSP monitoring at the monitoring location AM1(SR77) in the reporting month.
- 13.1.4 No exceedance of Action and Limit Level was recorded for 1-hour TSP monitoring at the monitoring location AM1(SR77) in the reporting month.
- 13.1.5 No noise complaint was received in the reporting month, so no Action Level exceedance was recorded. Also, no Limit Level exceedance of noise monitoring was recorded in the reporting month.
- 13.1.6 The 4-week post-construction water quality monitoring at I5 was completed in April 2017.
- 13.1.7 Four (4) environmental site inspections were carried out in the reporting month. Recommendations on remedial actions were given to the Contractors for the deficiencies identified during the site audit.

13.2 Recommendations

- 13.2.1 According to the environmental site inspections performed in the reporting month, the following recommendation was provided:

Waste Management

- Housekeeping shall be enhanced and refuse shall be collected regularly

Figure

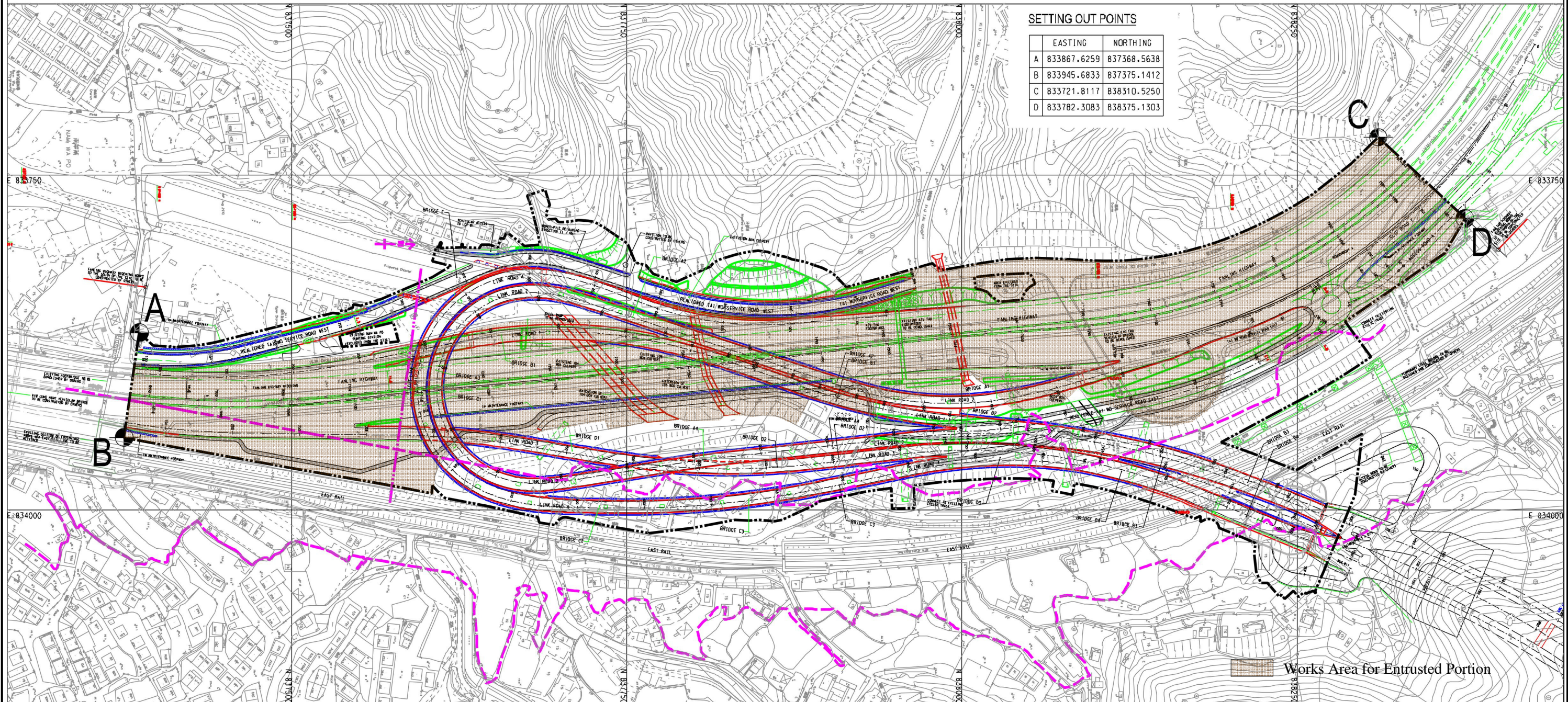

CV/201209-T-CWC-SK-001g_AD_edit.dgn 22/1/2014 17:10:34

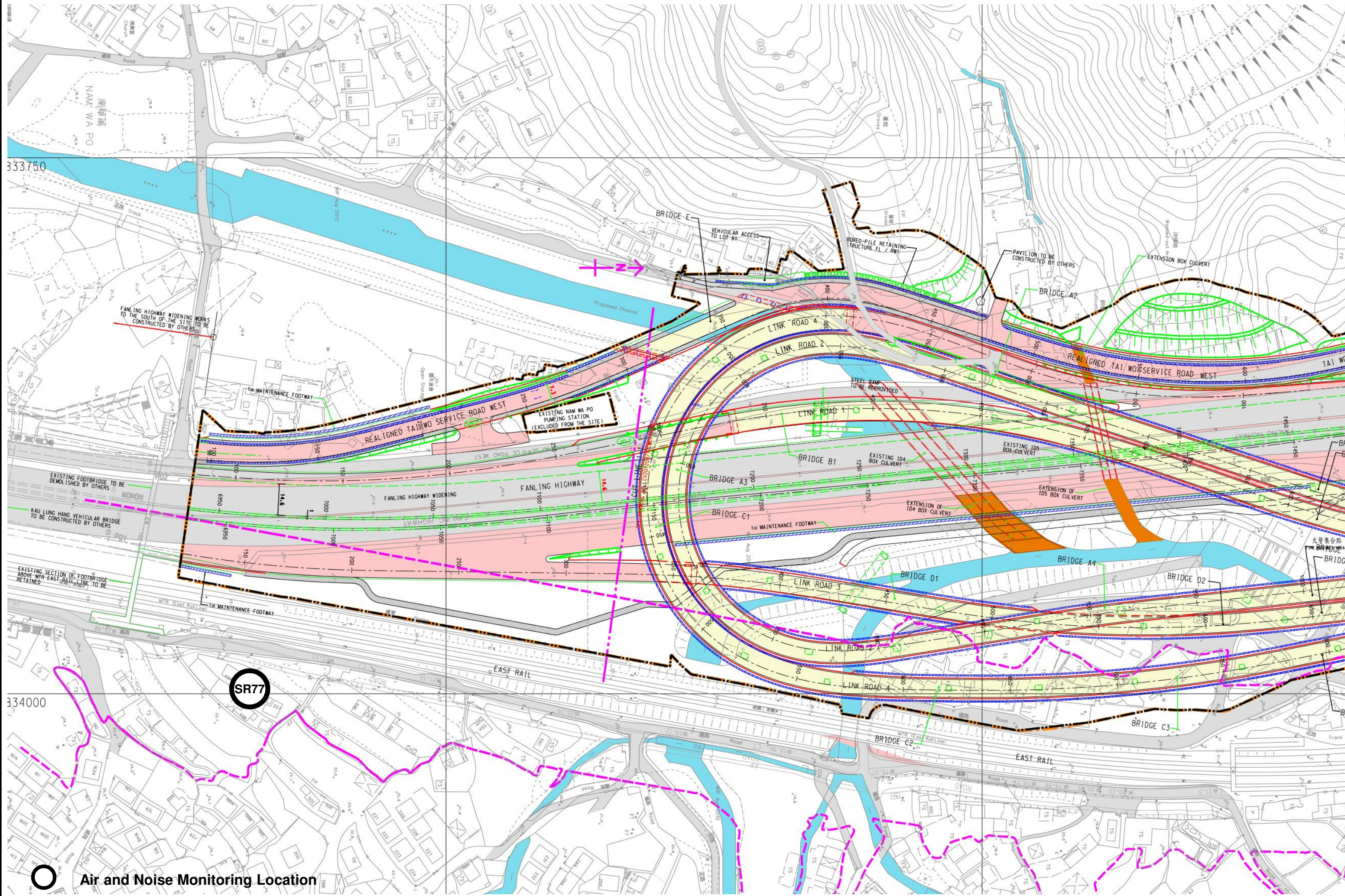

Appendix A Construction Programme

Activity ID	Activity Name	OD	RD	Start	Finish	TF	2017				2018	
							Sep	Oct	Nov	Dec	Jan	Feb
PI-A-1020L	Parapet Installation, Profile Barrier & Planter for Bridge A (AA5-AA9), LHS	60	0	07-Sep-17 A	17-Oct-17 A		Parapet Installation, Profile Barrier & Planter for Bridge A (AA5-AA9), LHS					
PI-A-1040R	Parapet Installation, Profile Barrier & Planter for Bridge A (AA13-AA18), RHS	50	10	11-Sep-17 A	01-Nov-17	16	Parapet Installation, Profile Barrier & Planter for Bridge A (AA13-AA18), RHS, Parapet Installation, Profile Barrier & Planter for Bridge A (AA13-AA18), RHS					
PI-A-1010R	Parapet Installation, Profile Barrier & Planter for Bridge A (AA1-AA5), RHS	42	25	27-Sep-17 A	18-Nov-17	1	Parapet Installation, Profile Barrier & Planter for Bridge A (AA1-AA5), RHS, Parapet Installation, Profile Barrier & Planter for Bridge A (AA1-AA5), RHS					
PI-A-1020R	Parapet Installation, Profile Barrier & Planter for Bridge A (AA5-AA9), RHS	34	15	16-Oct-17 A	07-Nov-17	11	Parapet Installation, Profile Barrier & Planter for Bridge A (AA5-AA9), RHS, Parapet Installation, Profile Barrier & Planter for Bridge A (AA5-AA9), RHS					
PI-A-1050L	Parapet Installation, Profile Barrier for Bridge A (AA18-AB10E), LHS	50	50	20-Oct-17	18-Dec-17	-24	Parapet Installation, Profile Barrier for Bridge A (AA18-AB10E), LHS					
PI-A-1060R	Parapet Installation, Profile Barrier & Planter for Bridge A (AB10E-AB12E), RHS remaining	50	50	20-Oct-17	18-Dec-17	-24	Parapet Installation, Profile Barrier & Planter for Bridge A (AB10E-AB12E), RHS remaining					
PI-A-1050R	Parapet Installation, Profile Barrier for Bridge A (AA18-AB10E), RHS	16	16	20-Oct-17	08-Nov-17	10	Parapet Installation, Profile Barrier for Bridge A (AA18-AB10E), RHS					
PI-A-1060RM	Parapet Installation for Bridge A (AB10E-AB12E), RHS above MTRC railway	31	31	20-Oct-17	25-Nov-17	-5	Parapet Installation for Bridge A (AB10E-AB12E), RHS above MTRC railway					
Bridge B												
PI-B-1010R	Parapet Installation, Profile Barrier & Planter for Bridge B (AB1-AB6), RHS	103	10	01-Aug-17 A	01-Nov-17	0	Parapet Installation, Profile Barrier & Planter for Bridge B (AB1-AB6), RHS, Parapet Installation, Profile Barrier & Planter for Bridge B (AB1-AB6), RHS					
PI-B-1010L	Parapet Installation, Profile Barrier for Bridge B (AB1-AB6), LHS	103	15	04-Aug-17 A	07-Nov-17	-5	Parapet Installation, Profile Barrier for Bridge B (AB1-AB6), LHS, Parapet Installation, Profile Barrier for Bridge B (AB1-AB6), LHS					
PI-B-1020L	Parapet Installation, Profile Barrier for Bridge B (AB6-AB10W), LHS	44	20	05-Sep-17 A	13-Nov-17	-10	Parapet Installation, Profile Barrier for Bridge B (AB6-AB10W), LHS, Parapet Installation, Profile Barrier for Bridge B (AB6-AB10W), LHS					
PI-B-1020R	Parapet Installation, Profile Barrier for Bridge B (AB6-AB10W), RHS	16	16	22-Sep-17 A	08-Nov-17	-6	Parapet Installation, Profile Barrier for Bridge B (AB6-AB10W), RHS, Parapet Installation, Profile Barrier for Bridge B (AB6-AB10W), RHS					
PI-B-1030LM	Parapet Installation for Bridge B (AB10W-AB12W), LHS above MTRC railway	31	31	20-Oct-17	25-Nov-17	-21	Parapet Installation for Bridge B (AB10W-AB12W), LHS above MTRC railway					
PI-B-1030L	Parapet Installation, Profile Barrier & Planter for Bridge B (AB10W-AB12W), LHS remaining	34	34	20-Oct-17	29-Nov-17	-24	Parapet Installation, Profile Barrier & Planter for Bridge B (AB10W-AB12W), LHS remaining					
Bridge C												
PI-C-1020L	Parapet Installation, Profile Barrier & Planter for Bridge C (AC5-AC8), LHS	59	15	15-Feb-17 A	07-Nov-17	-86	Parapet Installation, Profile Barrier & Planter for Bridge C (AC5-AC8), LHS, Parapet Installation, Profile Barrier & Planter for Bridge C (AC5-AC8), LHS					
PI-C-1020R	Parapet Installation, Profile Barrier & Planter for Bridge C (AC5-AC8), RHS	110	14	09-Mar-17 A	06-Nov-17	-85	Parapet Installation, Profile Barrier & Planter for Bridge C (AC5-AC8), RHS, Parapet Installation, Profile Barrier & Planter for Bridge C (AC5-AC8), RHS					
PI-C-1010R	Parapet Installation, Profile Barrier & Planter for Bridge C (AC1-AC5), RHS	84	27	12-Jul-17 A	21-Nov-17	-98	Parapet Installation, Profile Barrier & Planter for Bridge C (AC1-AC5), RHS, Parapet Installation, Profile Barrier & Planter for Bridge C (AC1-AC5), RHS					
PI-C-1010L	Parapet Installation, Profile Barrier for Bridge C (AC1-AC5), LHS	54	27	12-Jul-17 A	21-Nov-17	-98	Parapet Installation, Profile Barrier for Bridge C (AC1-AC5), LHS, Parapet Installation, Profile Barrier for Bridge C (AC1-AC5), LHS					
PI-C-1050RM1	Other Civil Works on Bridge Deck for TCSS duct laying - Bridge C	14	14	22-Nov-17	07-Dec-17	-98	Other Civil Works on Bridge Deck for TCSS duct laying - Bridge C					
Bridge D												
PI-D-1020R	Parapet Installation, Profile Barrier & Planter for Bridge D (AD5-AD8W), RHS	78	13	09-May-17 A	04-Nov-17	-27	Parapet Installation, Profile Barrier & Planter for Bridge D (AD5-AD8W), RHS, Parapet Installation, Profile Barrier & Planter for Bridge D (AD5-AD8W), RHS					
PI-D-1020L	Parapet Installation, Profile Barrier for Bridge D (AD5-AD8W), LHS	90	13	11-May-17 A	04-Nov-17	-27	Parapet Installation, Profile Barrier for Bridge D (AD5-AD8W), LHS, Parapet Installation, Profile Barrier for Bridge D (AD5-AD8W), LHS					
PI-D-1010R	Parapet Installation, Profile Barrier & Planter for Bridge D (AD1-AD5), RHS	83	18	16-Jun-17 A	10-Nov-17	-32	Parapet Installation, Profile Barrier & Planter for Bridge D (AD1-AD5), RHS, Parapet Installation, Profile Barrier & Planter for Bridge D (AD1-AD5), RHS					
PI-D-1010L	Parapet Installation, Profile Barrier & Planter for Bridge D (AD1-AD5), LHS	52	18	03-Jul-17 A	10-Nov-17	-32	Parapet Installation, Profile Barrier & Planter for Bridge D (AD1-AD5), LHS, Parapet Installation, Profile Barrier & Planter for Bridge D (AD1-AD5), LHS					
Roadworks, Road Facilities and Miscellaneous inside Viaduct Internal Voids												
RS-1030	Movement Joints and Road Furniture incl. Deck Drainage, Lightings, Steel Rails,NB, Water Main for Bridge D (AD1 to AD8)	80	80	07-Nov-17	10-Feb-18	-44	Movement Joints and Road Furniture incl. Deck Drainage, Lightings, Steel Rails,NB, Water Main for Bridge D (AD1 to AD8)					
RS-1000	Movement Joints and Road Furniture incl. Deck Drainage, Lightings, Steel Rails,NB, Water Main for Bridge A (AA1 to AB12)	140	140	07-Nov-17	04-May-18	-83	Movement Joints and Road Furniture incl. Deck Drainage, Lightings, Steel Rails,NB, Water Main for Bridge A (AA1 to AB12)					
RS-1010	Movement Joints and Road Furniture incl. Deck Drainage, Lightings, Steel Rails,NB, Water Main for Bridge B (AB1 to AB12)	120	120	07-Nov-17	10-Apr-18	-63	Movement Joints and Road Furniture incl. Deck Drainage, Lightings, Steel Rails,NB, Water Main for Bridge B (AB1 to AB12)					
RS-1020	Movement Joints and Road Furniture incl. Deck Drainage, Lightings, Steel Rails,NB, Water Main for Bridge C (AC1 to AD10)	100	100	07-Nov-17	13-Mar-18	-64	Movement Joints and Road Furniture incl. Deck Drainage, Lightings, Steel Rails,NB, Water Main for Bridge C (AC1 to AD10)					
Section VI - Works in Portion FH9 (KD-6A)												

3-Month Rolling Programme updated to 2017-10-20			
Date	Revision	Checked	Approved

Appendix B

Project Organization Structure

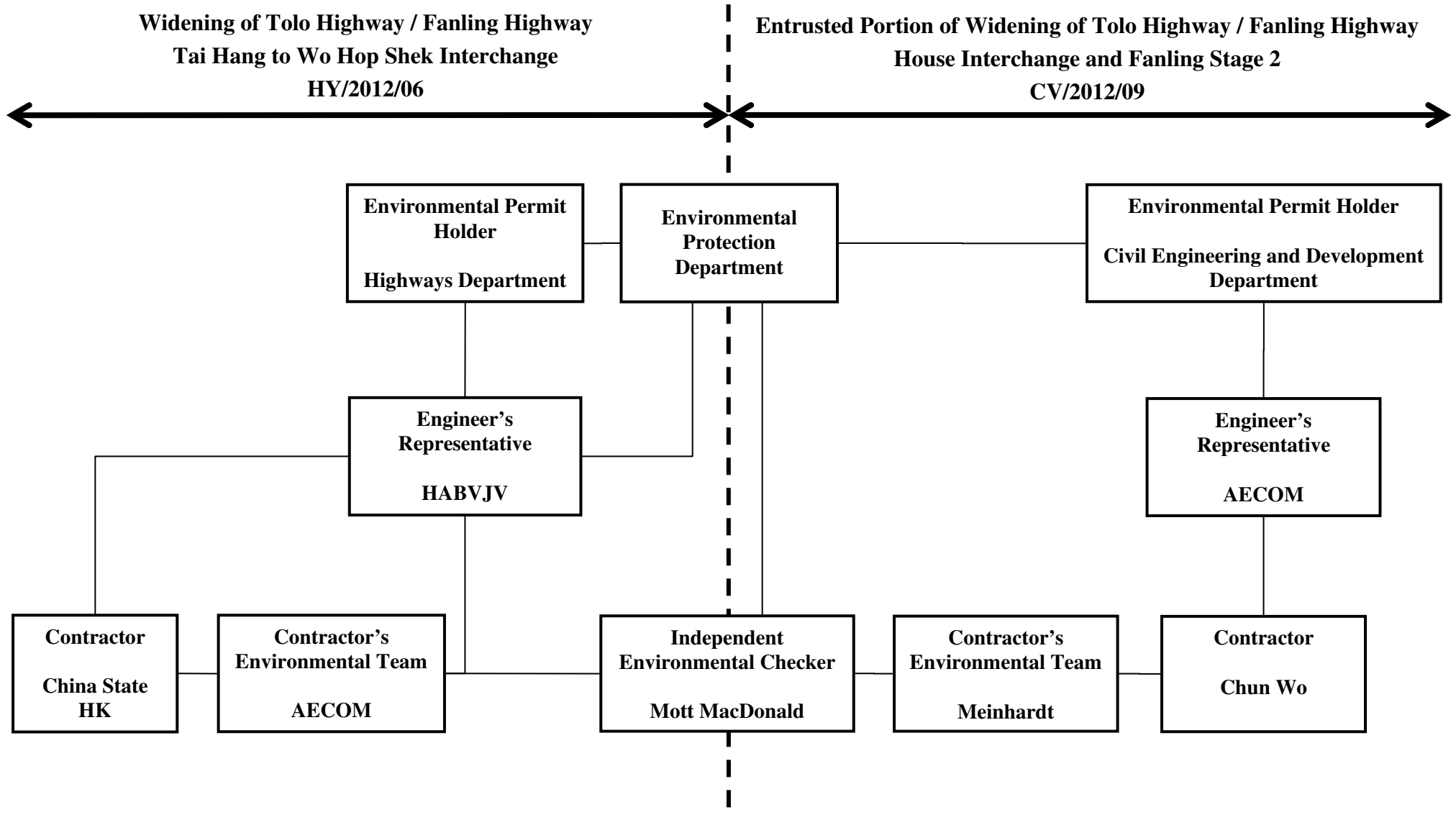

Appendix C Calibration Certificates of Monitoring Equipment



TISCH ENVIRONMENTAL, INC.
 145 SOUTH MIAMI AVE
 VILLAGE OF CLEVELAND, OH
 45002
 513.467.9000
 877.263.7610 TOLL FREE
 513.467.9009 FAX

ORIFICE TRANSFER STANDARD CERTIFICATION WORKSHEET TE-5025A

Date - Feb 28, 2017 Rootmeter S/N 0438320 Ta (K) - 294
 Operator Tisch Orifice I.D. - 1941 Pa (mm) - 750.57

PLATE OR Run #	VOLUME START (m3)	VOLUME STOP (m3)	DIFF VOLUME (m3)	DIFF TIME (min)	METER	ORFICE
					DIFF Hg (mm)	DIFF H2O (in.)
1	NA	NA	1.00	1.4600	3.2	2.00
2	NA	NA	1.00	1.0410	6.4	4.00
3	NA	NA	1.00	0.9280	7.9	5.00
4	NA	NA	1.00	0.8840	8.7	5.50
5	NA	NA	1.00	0.7290	12.7	8.00

DATA TABULATION

Vstd	(x axis) Qstd	(y axis)	Va	(x axis) Qa	(y axis)
0.9967	0.6827	1.4149	0.9957	0.6820	0.8851
0.9925	0.9534	2.0010	0.9915	0.9524	1.2517
0.9904	1.0672	2.2372	0.9894	1.0661	1.3995
0.9894	1.1192	2.3464	0.9884	1.1181	1.4678
0.9840	1.3499	2.8299	0.9830	1.3485	1.7702
Qstd slope (m) = 2.11965			Qa slope (m) = 1.32729		
intercept (b) = -0.02696			intercept (b) = -0.01686		
coefficient (r) = 0.99991			coefficient (r) = 0.99991		
y axis = SQRT[H2O (Pa/760) (298/Ta)]			y axis = SQRT[H2O (Ta/Pa)]		

CALCULATIONS

$$Vstd = \text{Diff. Vol} [(Pa - \text{Diff. Hg}) / 760] (298 / Ta)$$

$$Qstd = Vstd / \text{Time}$$

$$Va = \text{Diff Vol} [(Pa - \text{Diff Hg}) / Pa]$$

$$Qa = Va / \text{Time}$$

For subsequent flow rate calculations:

$$Qstd = 1/m \{ [\text{SQRT} (H2O (Pa/760) (298/Ta))] - b \}$$

$$Qa = 1/m \{ [\text{SQRT} H2O (Ta/Pa)] - b \}$$

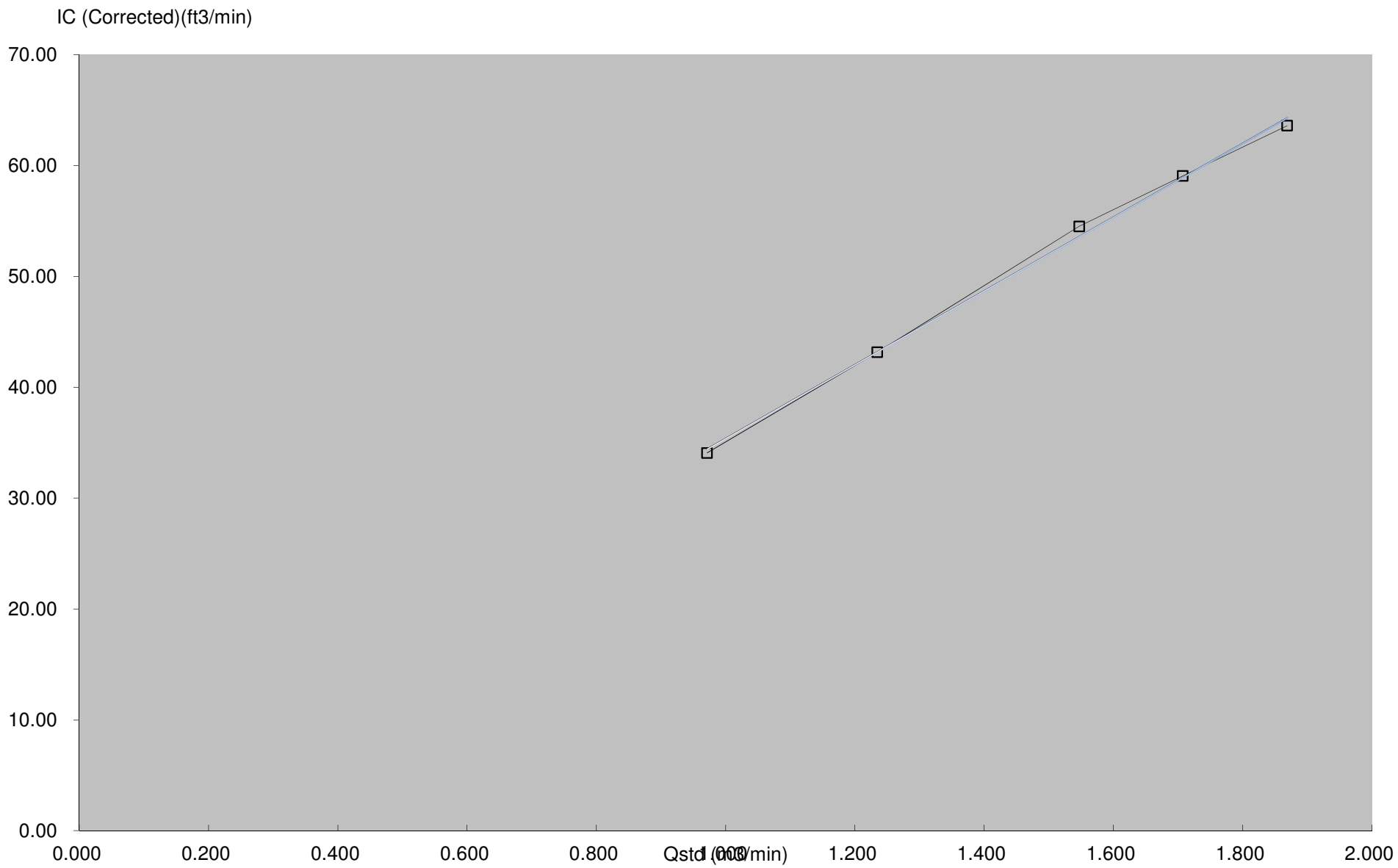



Calibration Certificate

Certificate No. **708774**

Page 1 of 2 Pages

Customer : Enovative Environmental Service Limited

Address : Flat 6, 3/F, Block E, Wah Lok Industrial Centre, 31-35 Shan Mei Street, Shatin, N.T., Hong Kong.

Order No. : Q73499

Date of receipt : 1-Sep-17

Item Tested

Description : Sound Level Calibrator

Manufacturer : Rion

I.D. : 215901

Model : NC-74

Serial No. : 34857296

Test Conditions

Date of Test : 4-Sep-17

Supply Voltage : --

Ambient Temperature : $(23 \pm 3)^{\circ}\text{C}$

Relative Humidity : $(50 \pm 25) \%$

Test Specifications

Calibration check.

Ref. Document/Procedure : F21, Z02, IEC 60942.

Test Results

All results were within the IEC 60942 Class 1 specification.

The results are shown in the attached page(s).

Main Test equipment used:

<u>Equipment No.</u>	<u>Description</u>	<u>Cert. No.</u>	<u>Traceable to</u>
S014	Spectrum Analyzer	707126	NIM-PRC & SCL-HKSAR
S240	Sound Level Calibrator	703741	NIM-PRC & SCL-HKSAR
S041	Universal Counter	707135	SCL-HKSAR
S206	Sound Level Meter	707129	SCL-HKSAR

The values given in this Calibration Certificate only relate to the values measured at the time of the test and any uncertainties quoted will not include allowance for the equipment long term drift, variations with environmental changes, vibration and shock during transportation, overloading, mis-handling, or the capability of any other laboratory to repeat the measurement. Hong Kong Calibration Ltd. shall not be liable for any loss or damage resulting from the use of the equipment.

The test equipment used for calibration are traceable to International System of Units (SI), or by reference to a natural constant.

The test results apply to the above Unit-Under-Test only

Calibrated by : _____
Elva Chong

Approved by : _____
Alan Chu

This Certificate is issued by:

Hong Kong Calibration Ltd.

Unit 8B, 24/F., Well Fung Industrial Centre, No. 58-76, Ta Chuen Ping Street, Kwai Chung, NT, Hong Kong.

Tel: 2425 8801 Fax: 2425 8646

Date: 4-Sep-17

Calibration Certificate

Certificate No. 708774

Page 2 of 2 Pages

Results :

1. Level Accuracy (at 1 kHz)

UUT Nominal Value	Measured Value	Mfr's Spec.
94 dB	94.1 dB	± 1 dB

Uncertainty : ± 0.2 dB

2. Frequency Accuracy

UUT Nominal Value	Measured Value	Mfr's Spec.
1 kHz	0.998 kHz	± 2 %

Uncertainty : ± 0.1 %

3. Level Stability : 0.0 dB

Uncertainty : ± 0.01 dB

4. Total Harmonic Distortion : $< 1.5\%$

Mfr's Spec. : < 3 %

Uncertainty : ± 2.3 % of reading

Remarks: 1. UUT : Unit-Under-Test
2. The uncertainty claimed is for a confidence probability of not less than 95%.
3. Atmospheric Pressure : 1 025 hPa

----- END -----

Calibration Certificate

Certificate No. **708773**

Page 1 of 3 Pages

Customer : Enovative Environmental Service Limited

Address : Flat 6, 3/F, Block E, Wah Lok Industrial Centre, 31-35 Shan Mei Street, Shatin, N.T., Hong Kong.

Order No. : Q73499

Date of receipt : 1-Sep-17

Item Tested

Description : Sound Level Meter

Manufacturer : Rion

I.D. : --

Model : NL-52

Serial No. : 00821072

Test Conditions

Date of Test : 5-Sep-17

Supply Voltage : --

Ambient Temperature : $(23 \pm 3)^{\circ}\text{C}$

Relative Humidity : $(50 \pm 25) \%$

Test Specifications

Calibration check.

Ref. Document/Procedure: Z01, IEC 61672.

Test Results

All results were within the IEC 61672 Type1 or manufacturer's specification.

The results are shown in the attached page(s).

Main Test equipment used:

<u>Equipment No.</u>	<u>Description</u>	<u>Cert. No.</u>	<u>Traceable to</u>
S017	Multi-Function Generator	C170120	SCL-HKSAR
S240	Sound Level Calibrator	703741	NIM-PRC & SCL-HKSAR

The values given in this Calibration Certificate only relate to the values measured at the time of the test and any uncertainties quoted will not include allowance for the equipment long term drift, variations with environmental changes, vibration and shock during transportation, overloading, mis-handling, or the capability of any other laboratory to repeat the measurement. Hong Kong Calibration Ltd. shall not be liable for any loss or damage resulting from the use of the equipment.

The test equipment used for calibration are traceable to International System of Units (SI), or by reference to a natural constant.
The test results apply to the above Unit-Under-Test only

Calibrated by : _____
Elva Chong

Approved by : _____
Alan Chu

This Certificate is issued by:

Hong Kong Calibration Ltd.

Unit 8B, 24/F., Well Fung Industrial Centre, No. 58-76, Ta Chuen Ping Street, Kwai Chung, NT, Hong Kong.

Tel: 2425 8801 Fax: 2425 8646

Date: 5-Sep-17

Calibration Certificate

Certificate No. 708773

Page 2 of 3 Pages

Results :

1. Self-generated noise: 16.4 dBA (Mfr's Spec \leq 17 dBA)

2. Acoustical signal test

UUT Setting				Applied Value (dB)	UUT Reading (dB)	
Range (dB)	Frequency Weighting	Time Weighting	Octave Filter			
20-130	A	F	OFF	94.0	94.1	
		S	OFF		94.1	
	C	F	OFF		94.1	
	Z	F	OFF		94.1	
	A	F	OFF	114.0	114.1	
			OFF		114.1	
		C	F		OFF	114.1
			F		OFF	114.1

IEC 61672 Type 1 Spec. : ± 1.1 dB

Uncertainty : ± 0.1 dB

3 Electrical signal tests of frequency weightings (A weighting)

Frequency	Attenuation (dB)	IEC 61672 Type 1 Spec.
31.5 Hz	-39.7	- 39.4 dB, ± 2 dB
63 Hz	-26.2	- 26.2 dB, ± 1.5 dB
125 Hz	-16.2	- 16.1 dB, ± 1.5 dB
250 Hz	-8.7	- 8.6 dB, ± 1 dB
500 Hz	-3.2	- 3.2 dB, ± 1.4 dB
1 kHz	0.0 (Ref)	0 dB, ± 1.1 dB
2 kHz	+1.2	+ 1.2 dB, ± 1.6 dB
4 kHz	+1.0	+ 1.0 dB, ± 1.6 dB
8 kHz	-1.1	- 1.1 dB, + 2.1 dB \sim -3.1 dB
16 kHz	-8.0	- 6.6 dB, + 3.5 dB \sim - 17.0 dB

Uncertainty : ± 0.1 dB

Calibration Certificate

Certificate No. 708773

Page 3 of 3 Pages

4. Frequency & Time weightings at 1 kHz

4.1 Frequency Weighting (Fast)

UUT Setting	Applied Value (dB)	UUT Reading (dB)	Difference (dB)	IEC 61672 Type 1 Spec.
A	94.0	94.0 (Ref.)	--	± 0.4 dB
C	94.0	94.0	0.0	
Z	94.0	94.0	0.0	

4.2 Time Weighting (A-weighted)

UUT Setting	Applied Value (dB)	UUT Reading (dB)	Difference (dB)	IEC 61672 Type 1 Spec.
Fast	94.0	94.0 (Ref.)	--	± 0.3 dB
Slow	94.0	94.0	0.0	
Time-averaging	94.0	94.0	0.0	

Uncertainty : ± 0.1 dB

Remarks : 1. UUT : Unit-Under-Test

2. The uncertainty claimed is for a confidence probability of not less than 95%.

3. Atmospheric Pressure : 1 028hPa.

4. Preamplifier model : NH-25 , S/N : 10553

5. Microphone model: UC-59 , S/N : 07040

6. Power Supply Check: OK

7. The UUT was adjusted with the supplied sound calibrator at the reference sound pressure level before the calibration.

----- END -----

Appendix D

EM&A Monitoring Schedules

**Entrusted Portion of Widening of Tolo Highway / Fanling Highway between Island House Interchange and Fanling Stage 2
Impact Monitoring & Site Auditing Schedule for November 2017**

November 2017						
Sun	Mon	Tue	Wed	Thu	Fri	Sat
			1	2 ET Site Walk(09:30am – 11:00am)	3	4
5	6 24-hour TSP + 3 x 1-hour TSP, Noise (SR77)	7	8	9 ET Site Walk(09:30am – 11:00am)	10 24-hour TSP + 3 x 1-hour TSP	11
12	13	14	15 ET Site Walk(09:30 am – 11:00 am) with Liantang Project-wide ET and IEC + SSEMC (To be confirmed)	16 24-hour TSP + 3 x 1-hour TSP, Noise (SR77)	17	18
19	20	21	22 24-hour TSP + 3 x 1-hour TSP, Noise (SR77)	23 ET Site Walk(09:30am – 11:00am)	24	25
26	27	28 24-hour TSP + 3 x 1-hour TSP, Noise (SR77)	29	30 ET Site Walk(09:30am – 11:00 am) with Fanling Stage 2 IEC & Liantang Project-wide ET and IEC (To be confirmed)		

**Entrusted Portion of Widening of Tolo Highway / Fanling Highway between Island House Interchange and Fanling Stage 2
Impact Monitoring & Site Auditing Schedule for October 2017**

October 2017						
Sun	Mon	Tue	Wed	Thu	Fri	Sat
1	2 The day following National Day	3 ET Site Walk(09:30am – 11:00am) 24-hour TSP + 3 x 1-hour TSP, Noise (SR77)	4	5 The day following the Chinese Mid-Autumn Festival	6	7
8	9 24-hour TSP + 3 x 1-hour TSP, Noise (SR77)	10	11	12 ET Site Walk(09:30am – 11:00am)	13 24-hour TSP + 3 x 1-hour TSP	14
15	16	17	18 ET Site Walk(09:30 am – 11:00 am) with Liantang Project-wide ET and IEC + SSEMC	19 24-hour TSP + 3 x 1-hour TSP, Noise (SR77)	20	21
22	23	24	25 24-hour TSP + 3 x 1-hour TSP, Noise (SR77)	26 ET Site Walk(09:30am – 11:00 am) with Fanling Stage 2 IEC & Liantang Project-wide ET and IEC	27	28 Chung Yeung Festival
29	30	31 24-hour TSP + 3 x 1-hour TSP, Noise (SR77)				

Appendix E

Meteorological Data Extracted from Hong Kong Observatory

Daily Extract of Meteorological Observations , October 2017

Day	Hong Kong Observatory								King's Park	Waglan Island [^]	
	Mean Pressure (hPa)	Air Temperature			Mean Dew Point (deg. C)	Mean Relative Humidity (%)	Mean Amount of Cloud (%)	Total Rainfall (mm)	Total Bright Sunshine (hours)	Prevailing Wind Direction (degrees)	Mean Wind Speed (km/h)
		Absolute Daily Max (deg. C)	Mean (deg. C)	Absolute Daily Min (deg. C)							
01	1011.7	30.1	28.4	27.6	25.9	86	80	6.6	***	***	***
02	1011.1	32.7	29.2	26.4	26.0	83	66	3.6	***	***	***
03	1012.3	33.5	30.1	28.3	25.8	78	52	0.0	***	***	***
04	1014.0	31.0	28.7	27.5	25.3	82	78	9.5	***	***	***
05	1013.3	30.3	28.5	27.5	23.8	76	76	Trace	***	***	***
06	1013.1	31.1	28.9	27.4	23.9	75	83	0.2	***	***	***
07	1013.0	31.7	29.3	27.9	24.2	74	76	0.0	***	***	***
08	1011.8	31.5	28.9	27.3	23.9	75	82	0.0	***	***	***
09	1010.1	30.9	29.4	28.1	23.6	71	85	Trace	***	***	***
10	1010.8	32.3	29.8	28.6	24.5	74	69	Trace	***	***	***
11	1011.2	32.5	29.8	28.3	24.4	73	43	0.2	***	***	***
12	1009.9	32.7	29.5	27.6	23.1	69	69	0.0	***	***	***
13	1007.9	30.6	27.0	24.5	19.5	64	59	0.0	***	***	***
14	1004.5	25.6	24.5	21.9	18.1	68	88	0.4	***	***	***
15	1000.3	26.9	23.3	20.4	21.3	89	89	20.7	***	***	***
16	1008.1	27.5	26.7	25.6	25.0	91	88	17.1	***	***	***
17	1012.2	27.6	25.8	24.7	23.4	87	89	41.3	***	***	***
18	1013.0	29.5	26.2	24.0	21.1	74	67	Trace	***	***	***
19	1011.9	27.9	25.4	23.4	19.7	71	70	0.0	***	***	***
20	1012.1	27.8	24.1	22.3	18.1	69	72	0.0	***	***	***
21	1012.1	27.2	23.6	21.6	16.2	64	33	0.0	***	***	***
22	1012.4	26.3	22.9	20.2	14.7	60	9	0.0	***	***	***
23	1015.6	27.7	23.7	20.8	15.9	62	6	0.0	***	***	***
24	1018.5	27.3	24.4	22.5	17.3	65	14	0.0	***	***	***
25	1018.8	26.4	24.1	22.7	18.1	69	18	Trace	***	***	***
26	1016.3	28.1	24.4	22.1	18.7	71	18	0.0	***	***	***
27	1013.9	28.6	24.9	22.1	16.4	60	40	0.0	***	***	***
28	1014.8	28.0	24.8	22.5	14.9	54	21	0.0	***	***	***
29	1018.0	27.0	24.1	21.7	13.9	53	31	0.0	***	***	***
30	1020.9	25.0	22.7	20.5	13.0	55	55	Trace	***	***	***
31	1019.7	25.0	22.0	19.0	14.1	61	51	Trace	***	***	***
Mean/Total	1012.7	29.0	26.3	24.4	20.4	71	57	99.6	***	***	***
Normal [§]	1014.1	27.8	25.5	23.7	20.2	73	58	100.9	193.9	080	27.4

*** unavailable

[^] Information of wind direction and wind speed for Waglan Island are based on automatic weather station data since January 1989

Trace means rainfall less than 0.05 mm

[§] 1981-2010 Climatological Normal, unless otherwise specified

Appendix F

Air Quality Monitoring Results and their Graphical Presentation

Appendix F
Air Quality Monitoring Results and their Graphical Presentation

24-Hour TSP Monitoring Result at Station: SR77

Sampling Date	Weather Condition	Starting Time	Paper No.	Wt. of paper (g)			Elapse Time			Flow Rate (CFM)			Flow Rate (m ³ /min)			Total Volume (m ³)	TSP Concentration (µg/m ³)	Action Level (µg/m ³)	Limit Level (µg/m ³)	Wind speed m/s	Wind direction	NOE	IR
				Initial Wt.	Final Wt.	Wt. of Dust	Initial	Final	Sampling Hour	Initial	Final	Avg Flow Rate	Initial	Final	Avg Flow Rate								
3-Oct-17	Sunny	12:11	CC94	2.8702	2.9816	0.1114	7168.67	7192.67	24.00	51	51	51.0	1.44	1.44	1.44	2079.59	53.6	170.3	260.0	<5	N		
9-Oct-17	Cloudy	12:12	CC96	2.8471	2.9727	0.1256	7195.67	7219.67	24.00	51	51	51.0	1.44	1.44	1.44	2079.59	60.4	170.3	260.0	<5	N		
13-Oct-17	Sunny	12:10	CC98	2.8352	3.1231	0.2879	7222.67	7246.67	24.00	51	51	51.0	1.44	1.44	1.44	2079.59	138.4	170.3	260.0	<5	N		
19-Oct-17	Fine	12:11	CC100	2.8611	3.0131	0.1520	7249.67	7276.67	27.00	51	51	51.0	1.44	1.44	1.44	2339.54	65.0	170.3	260.0	<5	N		
25-Oct-17	Sunny	12:10	CC102	2.8584	3.0483	0.1899	7279.67	7303.67	24.00	51	51	51.0	1.44	1.44	1.44	2079.59	91.3	170.3	260.0	<5	N		
31-Oct-17	Sunny	12:10	CC104	2.8589	3.1052	0.2463	7306.67	7330.67	24.00	51	51	51.0	1.44	1.44	1.44	2079.59	118.4	170.3	260.0	<5	N		
																Average	87.9						
																Min	53.6						
																Max	138.4						

Note: No major dust source observed during the monitoring period
Data in **Bold** denotes exceedance of respective Action Level
Data in **Bold Underline** denotes exceedance of respective Limit Level

24-Hour TSP Monitoring Result at Station: SR77

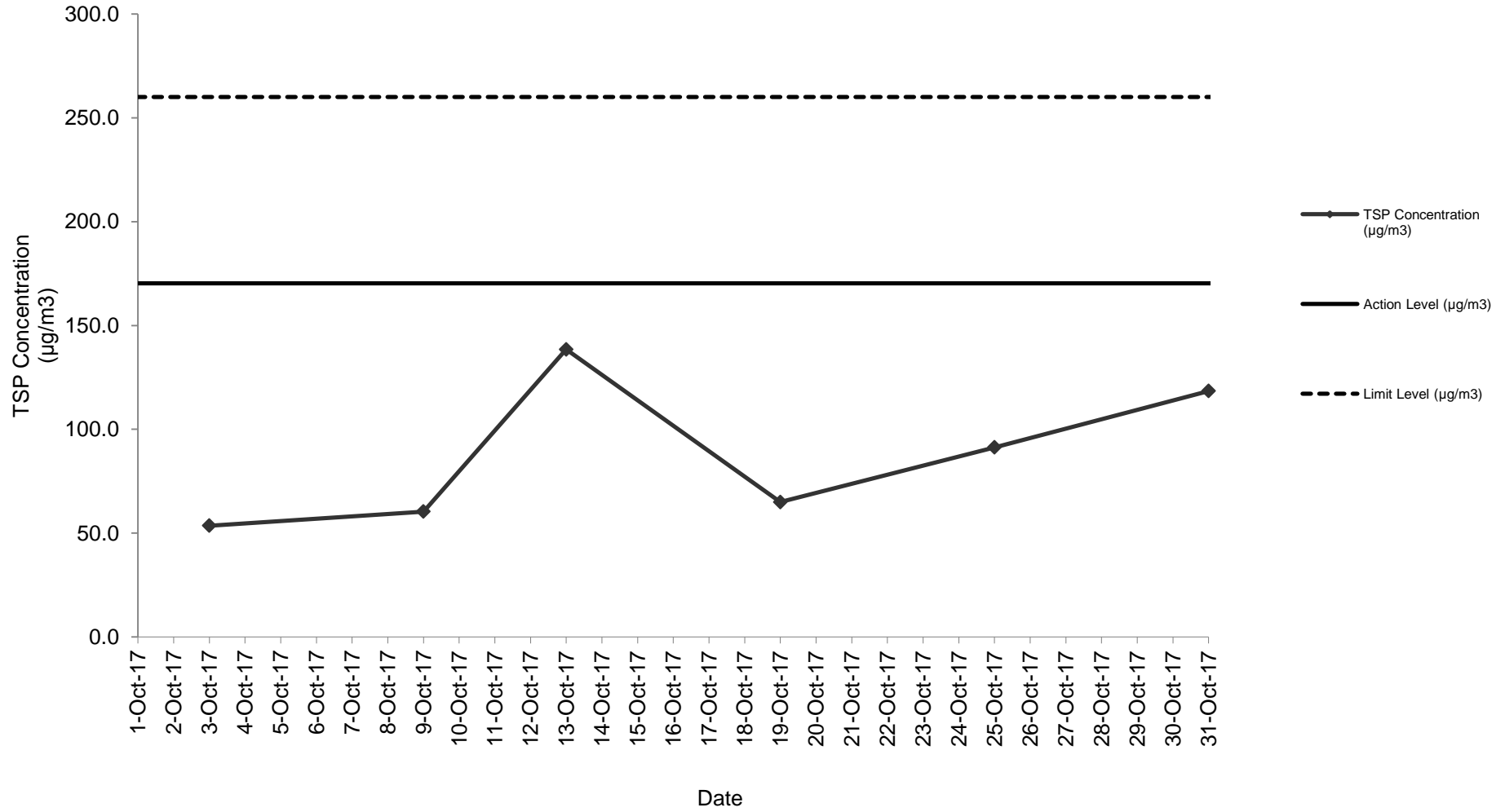

24-Hour TSP Monitoring Result at Station: SR77 (July 2017 - October 2017)

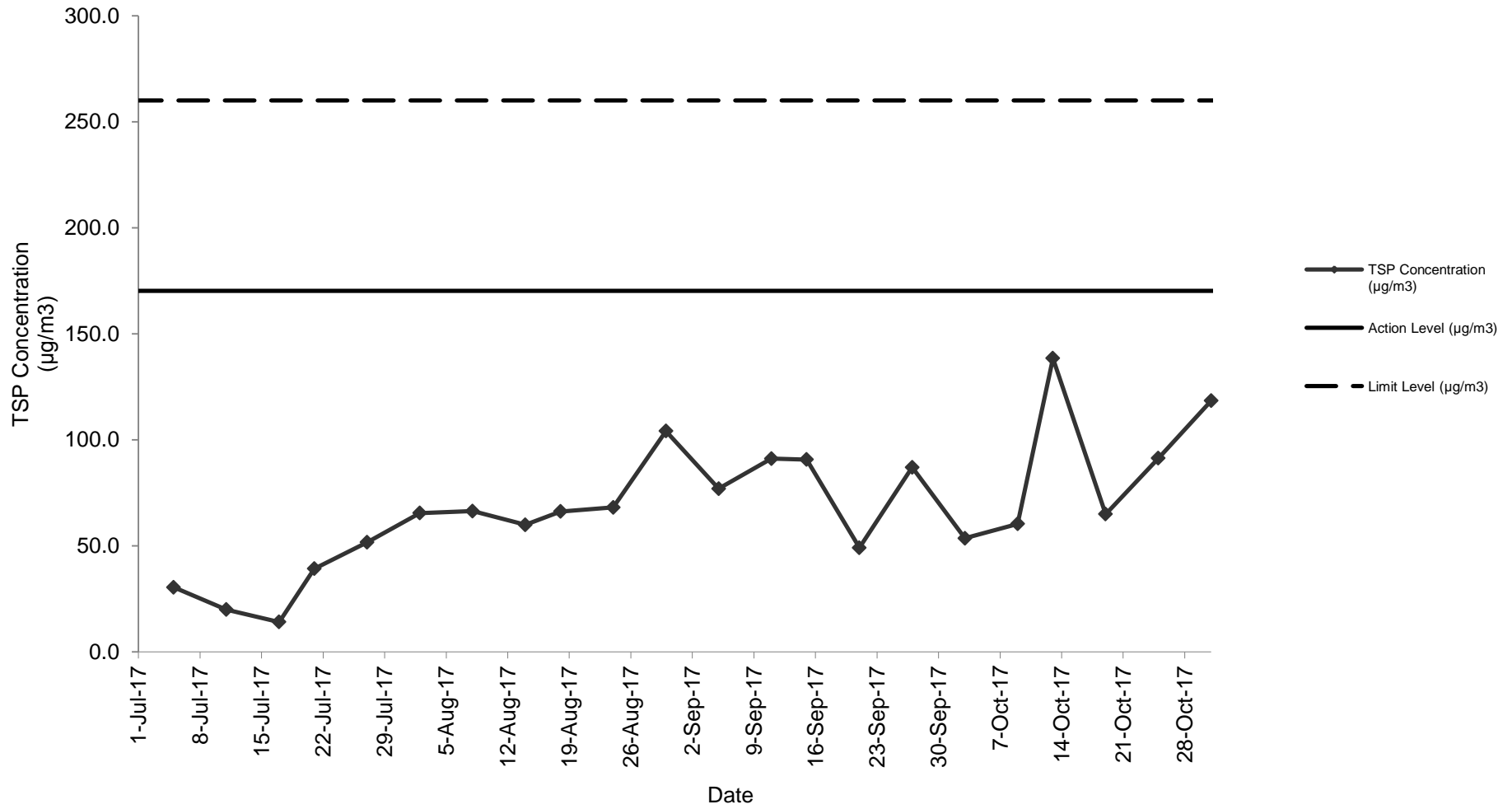

Appendix F
Air Quality Monitoring Results and their Graphical Presentation

Detailed Calculation of 1-Hour TSP Monitoring Result at Station: SR77

Sampling Date	Weather Condition	Starting Time	Paper No.	Wt. of paper (g)			Elapse Time			Flow Rate (CFM)			Flow Rate (m ³ /min)			Total Volume (m ³)	TSP Concentration (µg/m ³)	Action Level (µg/m ³)	Limit Level (µg/m ³)	Wind speed m/s	Wind direction
				Initial Wt.	Final Wt.	Wt. of Dust	Initial	Final	Sampling Hour	Initial	Final	Avg Flow Rate	Initial	Final	Avg Flow Rate						
3-Oct-17	Sunny	09:00	CC95A	2.8700	2.8791	0.0091	7165.67	7166.67	1.00	51	51	51.0	1.44	1.44	1.44	86.65	105.0	292.7	500.0	<5	N
	Sunny	10:03	CC95B	2.8541	2.8634	0.0093	7166.67	7167.67	1.00	51	51	51.0	1.44	1.44	1.44	86.65	107.3	292.7	500.0	<5	N
	Sunny	11:07	CC95C	2.8497	2.8579	0.0082	7167.67	7168.67	1.00	51	51	51.0	1.44	1.44	1.44	86.65	94.6	292.7	500.0	<5	N
9-Oct-17	Cloudy	09:00	CC97A	2.8486	2.8631	0.0145	7192.67	7193.67	1.00	51	51	51.0	1.44	1.44	1.44	86.65	167.3	292.7	500.0	<5	N
	Cloudy	10:03	CC97B	2.8114	2.8247	0.0133	7193.67	7194.67	1.00	51	51	51.0	1.44	1.44	1.44	86.65	153.5	292.7	500.0	<5	N
	Cloudy	11:06	CC97C	2.8276	2.8418	0.0142	7194.67	7195.67	1.00	51	51	51.0	1.44	1.44	1.44	86.65	163.9	292.7	500.0	<5	N
13-Oct-17	Sunny	09:00	CC99A	2.8566	2.8741	0.0175	7219.67	7220.67	1.00	51	51	51.0	1.44	1.44	1.44	86.65	202.0	292.7	500.0	<5	N
	Sunny	10:04	CC99B	2.8414	2.8591	0.0177	7220.67	7221.67	1.00	51	51	51.0	1.44	1.44	1.44	86.65	204.3	292.7	500.0	<5	N
	Sunny	11:08	CC99C	2.8622	2.8787	0.0165	7221.67	7222.67	1.00	51	51	51.0	1.44	1.44	1.44	86.65	190.4	292.7	500.0	<5	N
19-Oct-17	Fine	09:00	CC101A	2.8572	2.8671	0.0099	7246.67	7247.67	1.00	51	51	51.0	1.44	1.44	1.44	86.65	114.3	292.7	500.0	<5	N
	Fine	10:03	CC101B	2.8410	2.8522	0.0112	7247.67	7248.67	1.00	51	51	51.0	1.44	1.44	1.44	86.65	129.3	292.7	500.0	<5	N
	Fine	11:08	CC101C	2.8322	2.8409	0.0087	7248.67	7249.67	1.00	51	51	51.0	1.44	1.44	1.44	86.65	100.4	292.7	500.0	<5	N
25-Oct-17	Sunny	09:00	CC103A	2.8531	2.8668	0.0137	7276.67	7277.67	1.00	51	51	51.0	1.44	1.44	1.44	86.65	158.1	292.7	500.0	<5	N
	Sunny	10:04	CC103B	2.8441	2.8591	0.0150	7277.67	7278.67	1.00	51	51	51.0	1.44	1.44	1.44	86.65	173.1	292.7	500.0	<5	N
	Sunny	11:08	CC103C	2.8274	2.8418	0.0144	7278.67	7279.67	1.00	51	51	51.0	1.44	1.44	1.44	86.65	166.2	292.7	500.0	<5	N
31-Oct-17	Sunny	09:00	CC105A	2.8385	2.8579	0.0194	7303.67	7304.67	1.00	51	51	51.0	1.44	1.44	1.44	86.65	223.9	292.7	500.0	<5	N
	Sunny	10:03	CC105B	2.8119	2.8319	0.0200	7304.67	7305.67	1.00	51	51	51.0	1.44	1.44	1.44	86.65	230.8	292.7	500.0	<5	N
	Sunny	11:08	CC105C	2.8243	2.8447	0.0204	7305.67	7306.67	1.00	51	51	51.0	1.44	1.44	1.44	86.65	235.4	292.7	500.0	<5	N
																Average	162.2				
																Min	94.6				
																Max	235.4				

Note: No major dust source observed during the monitoring period
Data in **Bold** denotes exceedance of respective Action Level
Data in **Bold Underline** denotes exceedance of respective Limit Level

1-Hour TSP Monitoring Result at station: SR77

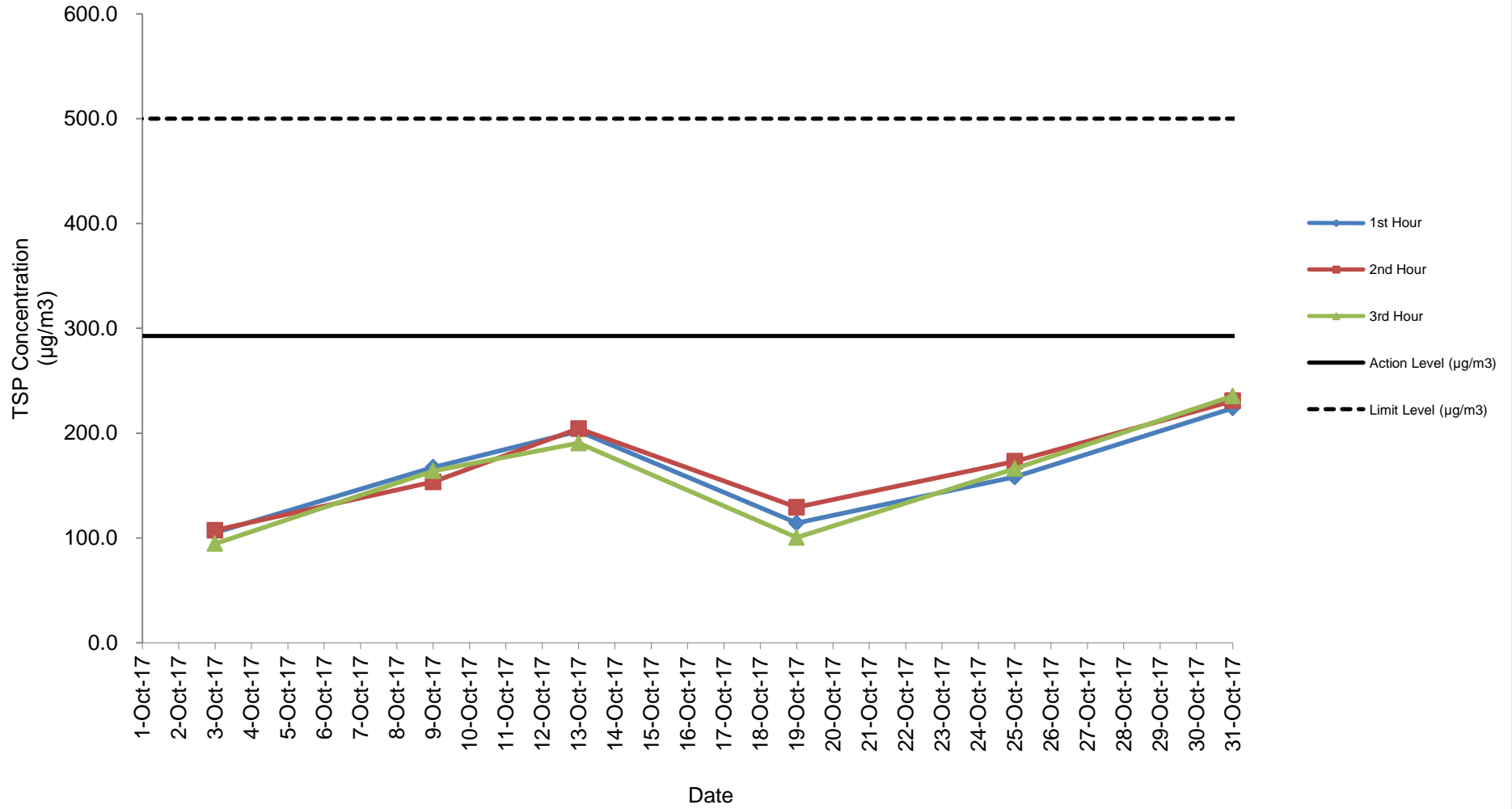

1-Hour TSP Monitoring Result at station: SR77 (July 2017 - October 2017)

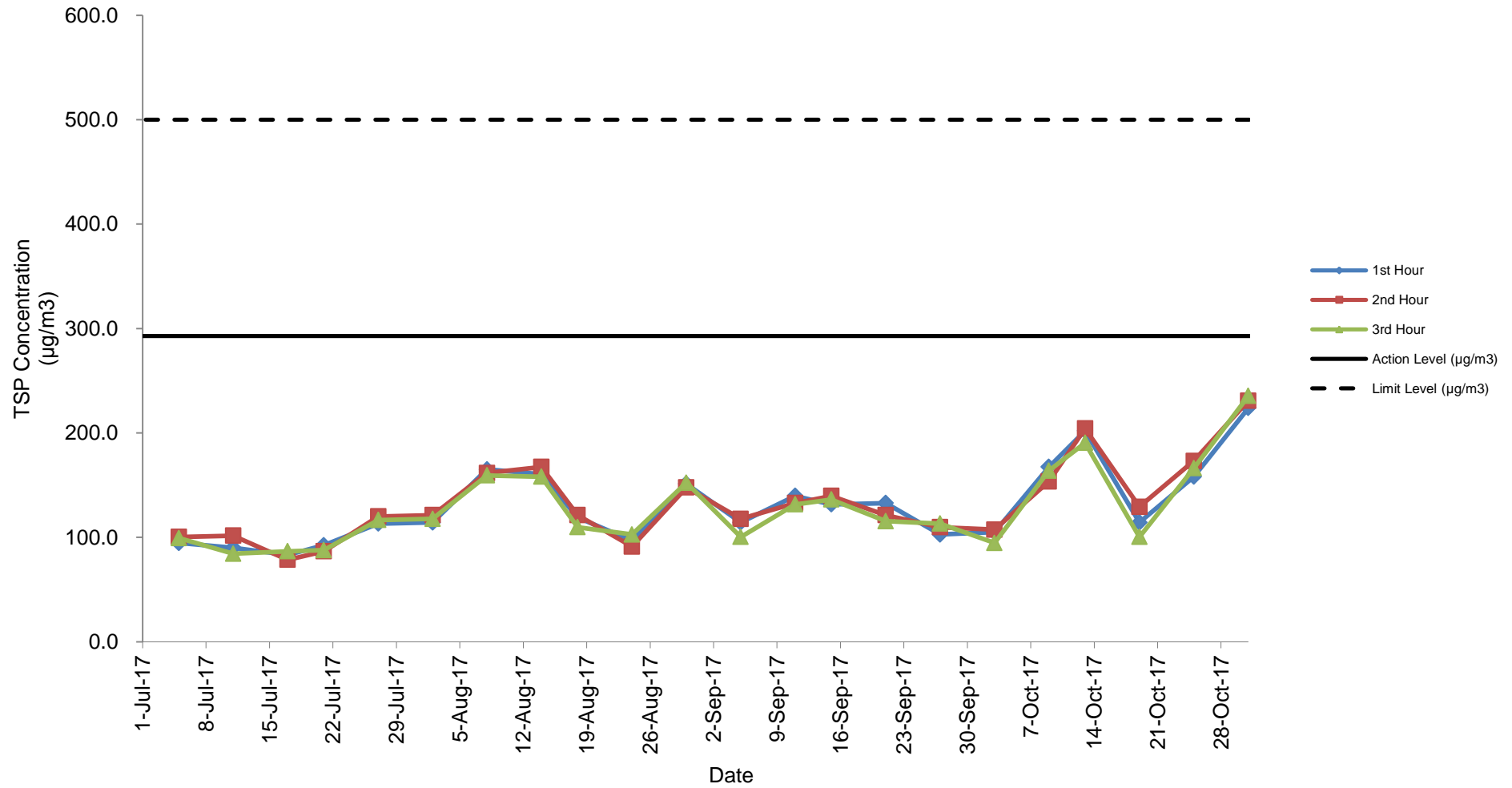

Appendix G

Summary of Event and Action Plan

Event and Action Plan for Air Quality

Event	Action			
	ET Leader	IEC	ER	Contractor
Action level being exceeded by one sampling day	<ol style="list-style-type: none"> 1. Identify source; 2. Inform IEC and ER; 3. Repeat measurement to confirm finding; 4. Increase monitoring frequency to daily. 	<ol style="list-style-type: none"> 1. Check monitoring data submitted by ET; 2. Check Contractor's working method. 	<ol style="list-style-type: none"> 1. Notify Contractor. 	<ol style="list-style-type: none"> 1. Rectify any unacceptable practice; 2. Amend working methods if appropriate.
Action level being exceeded by two or more consecutive sampling days	<ol style="list-style-type: none"> 1. Identify source; 2. Inform IEC and ER; 3. Repeat measurements to confirm findings; 4. Increase monitoring frequency to daily; 5. Discuss with IEC and Contractor on remedial actions required; 6. If exceedance continues, arrange meeting with IEC and ER; 7. If exceedance stops, cease additional monitoring. 	<ol style="list-style-type: none"> 1. Check monitoring data submitted by ET; 2. Check Contractor's working method; 3. Discuss with ET and Contractor on possible remedial measures; 4. Advise the ER on the effectiveness of the proposed remedial measures; 5. Supervise Implementation of remedial measures. 	<ol style="list-style-type: none"> 1. Confirm receipt of notification of failure in writing; 2. Notify Contractor; 3. Ensure remedial measures properly implemented. 	<ol style="list-style-type: none"> 1. Submit proposals for remedial actions to IEC within 3 working days of notification; 2. Implement the agreed proposals; 3. Amend proposal if appropriate.

Event	Action			
	ET Leader	IEC	ER	Contractor
Limit level being exceeded by one sampling day	<ol style="list-style-type: none"> 1. Identify source; 2. Inform IEC, ER, Contractor and EPD; 3. Repeat measurement to confirm finding; 4. Increase monitoring frequency to daily; 5. Assess effectiveness of Contractor's remedial actions and keep IEC, EPD and ER informed of the results. 	<ol style="list-style-type: none"> 1. Check monitoring data submitted by ET; 2. Check Contractor's working method; 3. Discuss with ET and Contractor on possible remedial measures; 4. Advise ER on the effectiveness of the proposed remedial measures; 5. Supervise implementation of remedial measures. 	<ol style="list-style-type: none"> 1. Confirm receipt of notification of exceedance in writing; 2. Notify Contractor; 3. Ensure remedial measures properly implemented. 	<ol style="list-style-type: none"> 1. Take immediate action to avoid further exceedance; 2. Submit proposals for remedial actions to IEC within 3 working days of notification; 3. Implement the agreed proposals; 4. Amend proposal if appropriate.
Limit level being exceeded by two or more consecutive sampling days	<ol style="list-style-type: none"> 1. Notify IEC, ER, Contractor, and EPD; 2. Identify source; 3. Repeat measurement to confirm findings; 4. Increase frequency to daily; 5. Analyse Contractor's working procedures to determine possible mitigation to be; 6. Arrange meeting with IEC and ER to discuss the remedial actions to be taken; 7. Assess effectiveness of Contractor's remedial actions and keep IEC, EPD and ER informed of the results; 8. If exceedance stops, cease additional monitoring. 	<ol style="list-style-type: none"> 1. Discuss amongst ER, ET, and Contractor on the potential remedial actions; 2. Review Contractor's remedial actions whenever necessary to assure their effectiveness and advise ER accordingly; 3. Supervise the implementation of remedial measures. 	<ol style="list-style-type: none"> 1. Confirm receipt of notification of exceedance in writing; 2. Notify Contractor; 3. In consultation with the IEC, agree with the Contractor on the remedial measures to be implemented; 4. Ensure remedial measures properly implemented; 5. If exceedance continues, consider what portion of the work is responsible and instruct the Contractor to stop that portion of work until the exceedance is abated. 	<ol style="list-style-type: none"> 1. Take immediate action to avoid further exceedance; 2. Submit proposals for remedial actions to IEC within 3 working days of notification; 3. Implement the agreed proposals; 4. Resubmit proposals if problem still not under control; 5. Stop the relevant portion of works as determined by ER until the exceedance is abated.

Event and Action Plan for Noise

Event	Action			
	ET Leader	IEC	ER	Contractor
Action Level	<ol style="list-style-type: none"> 1. Notify IEC and the Contractor. 2. Carry out investigation. 3. Report the results of investigation to IEC and the Contractor. 4. Discuss with the Contractor and formulate remedial measures. 5. Increase monitoring frequency to check mitigation effectiveness. 	<ol style="list-style-type: none"> 1. Review with analysed results submitted by ET. 2. Review the proposed remedial measures by the Contractor and advise ER accordingly. 3. Supervise the implement of remedial measures. 	<ol style="list-style-type: none"> 1. Confirm receipt of notification of failure in writing. 2. Notify the Contractor. 3. Require the Contractor to propose remedial measures for the analysed noise problem. 4. Ensure remedial measures are properly implemented. 	<ol style="list-style-type: none"> 1. Submit noise mitigation proposals to IEC. 2. Implement noise mitigation proposals.
Limit Level	<ol style="list-style-type: none"> 1. Notify IEC, ER, EPD and the Contractor. 2. Identify the source. 3. Repeat measurement to confirm findings. 4. Increase monitoring frequency. 5. Carry out analysis of Contractor's working procedures to determine possible mitigation to be implemented. 6. Inform IEC, ER, and EPD the causes & actions taken for the exceedances. 7. Assess effectiveness of the Contractor's remedial actions and keep IEC, EPD and ER informed of the results. 8. If exceedance stops, cease additional monitoring. 	<ol style="list-style-type: none"> 1. Discuss amongst ER, ET Leader and the Contractor on the potential remedial actions. 2. Review the Contractor's remedial actions whenever necessary to assure their effectiveness and advise ER accordingly. 3. Supervise the implementation of remedial measures. 	<ol style="list-style-type: none"> 1. Confirm receipt of notification of failure in writing. 2. Notify the Contractor. 3. Require the Contractor to propose remedial measures for the analysed noise problem. 4. Ensure remedial measures are properly implemented. 5. If exceedance continues, consider what activity of the work is responsible and instruct the Contractor to stop that activity of work until the exceedance is abated. 	<ol style="list-style-type: none"> 1. Take immediate action to avoid further exceedance. 2. Submit proposals for remedial actions to IEC within 3 working days of notification. 3. Implement the agreed proposals. 4. Resubmit proposals if problem still not under control. 5. Stop the relevant activity of works as determined by the ER until the exceedance is abated.

Event and Action Plan for Water Quality

Event	Action			
	ET Leader	IEC	ER	Contractor
Action level being exceeded by one sampling day	<ol style="list-style-type: none"> 1. Repeat in-situ measurement on next day of exceedance to confirm findings; 2. Identify source(s) of impact; 3. Inform IEC, Contractor & ER; 4. Check monitoring data, all plant, equipment & contractor's working methods; 	<ol style="list-style-type: none"> 1. Check monitoring data submitted by ET & Contractor's working methods; 	<ol style="list-style-type: none"> 1. Confirm receipt of notification of failure in writing; Notify, Contractor 	<ol style="list-style-type: none"> 1. Inform the ER & confirm notification of the non-compliance in writing; 2. Rectify unacceptable practice; 3. Amend working methods if appropriate.
Action level being exceeded by two or more consecutive sampling days	<ol style="list-style-type: none"> 1. Repeat measurement on next day of exceedance to confirm findings; 2. Identify source(s) of impact; 3. Inform IEC, Contractor, ER & EPD; 4. Check monitoring data, all plant, equipment & Contractor's working methods; 5. Discuss mitigation measures with IEC, ER & Contractor; 6. Ensure mitigation measures are implemented; 7. Increase monitoring to daily until no exceedance of Action level. 	<ol style="list-style-type: none"> 1. Checking monitoring data submitted by ET & Contractor's working method; 2. Discuss with ET & Contractor on possible remedial actions; 3. Review the proposed mitigation measures submitted by Contractor & advise the ER accordingly; 4. Supervise the implementation of mitigation measures. 	<ol style="list-style-type: none"> 1. Discuss with IEC on the proposed mitigation measures; 2. Ensure mitigation measures properly implemented; 3. Assess the effectiveness of the implemented mitigation measures. 	<ol style="list-style-type: none"> 1. Inform the Engineer & confirm notification of the non-compliance in writing; 2. Rectify unacceptable practice; 3. Check all plant & equipment & consider changes of working methods; 4. Submit proposal of mitigation measures to ER within 3 working days of notification & discuss with ET, IEC & ER; 5. Implement the agreed mitigation measures.

Event	Action			
	ET Leader	IEC	ER	Contractor
Limit level being exceeded by one sampling day	<ol style="list-style-type: none"> 1. Repeat measurement on next day of exceedance to confirm findings; 2. Identify source(s) of impact; 3. Inform IEC, contractor, ER & EPD; 4. Check monitoring data, all plant, equipment & contractor's working methods; 5. Discuss mitigation measures with IEC, Contractor & ER. 	<ol style="list-style-type: none"> 1. Checking monitoring data submitted by ET & Contractor's working method; 2. Discuss with ET & Contractor on the possible mitigation measures; 3. Review the proposed mitigation measures submitted by Contractor & advise the ER accordingly. 	<ol style="list-style-type: none"> 1. Confirm receipt of notification of failure in writing; 2. Discuss with IEC, ET & Contractor on the proposed mitigation measures; 3. Request Contractor to review the working methods. 	<ol style="list-style-type: none"> 1. Inform the ER & confirm notification of the non-compliance in writing; 2. Rectify unacceptable practice; 3. Check all plant & equipment & consider changes of working methods; 4. Submit proposal of mitigation measures to ER within 3 working days of notification & discuss with ET, IEC & ER.
Limit level being exceeded by two or more consecutive sampling days	<ol style="list-style-type: none"> 1. Repeat measurement on the next day of exceedance to confirm findings; 2. Identify source(s) of impact; 3. Inform IEC, Contractor, ER & EPD; 4. Check monitoring data, all plant, equipment & Contractor's working methods; 5. Discuss mitigation measures within IEC, Contractor & ER; 6. Ensure mitigation measures are implemented; 7. Increase the monitoring frequency to daily until no exceedance of Limit level for two consecutive days. 	<ol style="list-style-type: none"> 1. Checking monitoring data submitted by ET & Contractor's working method; 2. Discuss with ET & Contractor on potential remedial actions; 3. Review Contractor's mitigation measures whenever necessary to assure their effectiveness & advise the ER accordingly; 4. Supervise the implementation of mitigation measures. 	<ol style="list-style-type: none"> 1. Discuss with IEC, ET & Contractor on the proposed mitigation measures; 2. Request Contractor to critically review the working methods; 3. Make agreement on the mitigation measures to be implemented; 4. Ensure mitigation measures are properly implemented; 5. Consider & instruct, if necessary, the Contractor to slow down or to stop all or part of the construction activities until no exceedance of Limit level. 	<ol style="list-style-type: none"> 1. Take immediate action to avoid further exceedance; 2. Submit proposal of mitigation measures to ER within 3 working days of notification & discuss with ET, IEC & ER; 3. Implement the agreed mitigation measures; 4. Resubmit proposals of mitigation measures if problem still not under control; 5. As directed by the Engineer, to slow down or to stop all or part of the construction activities until no exceedance of Limit level.

Appendix H

Noise Monitoring Results and their Graphical Presentation

Appendix H
Noise Monitoring Results and their Graphical Presentation

Noise Monitoring Result at SR77

Date	Weather Condition	Start Time	End Time	Measured Noise Level (dB(A))*			Baseline Corrected Level, dB(A)**	Baseline Noise Level (dB(A)), Leq(30min)	Limit Level dB(A)	Exceedance (Y / N)
				L10(30min)	L90(30min)	Leq(30min)				
2017/10/03	Sunny	11:30	12:00	74.5	61.5	70.5	-	67.8	75.0	N
2017/10/09	Cloudy	11:30	12:00	89.0	64.5	73.0	-	67.8	75.0	N
2017/10/19	Fine	11:30	12:00	93.5	62.0	73.5	-	67.8	75.0	N
2017/10/25	Sunny	11:30	12:00	92.5	59.5	73.5	-	67.8	75.0	N
2017/10/31	Sunny	11:30	12:00	93.0	59.0	74.0	-	67.8	75.0	N
						Average	72.9			
						Minimum	70.5			
						Maximum	74.0			

Remarks

* +3dB(A) Façade effect correction included

** Baseline corrected level is only calculated when measured noise level (Leq) > limit level.

Noise monitoring result: SR77

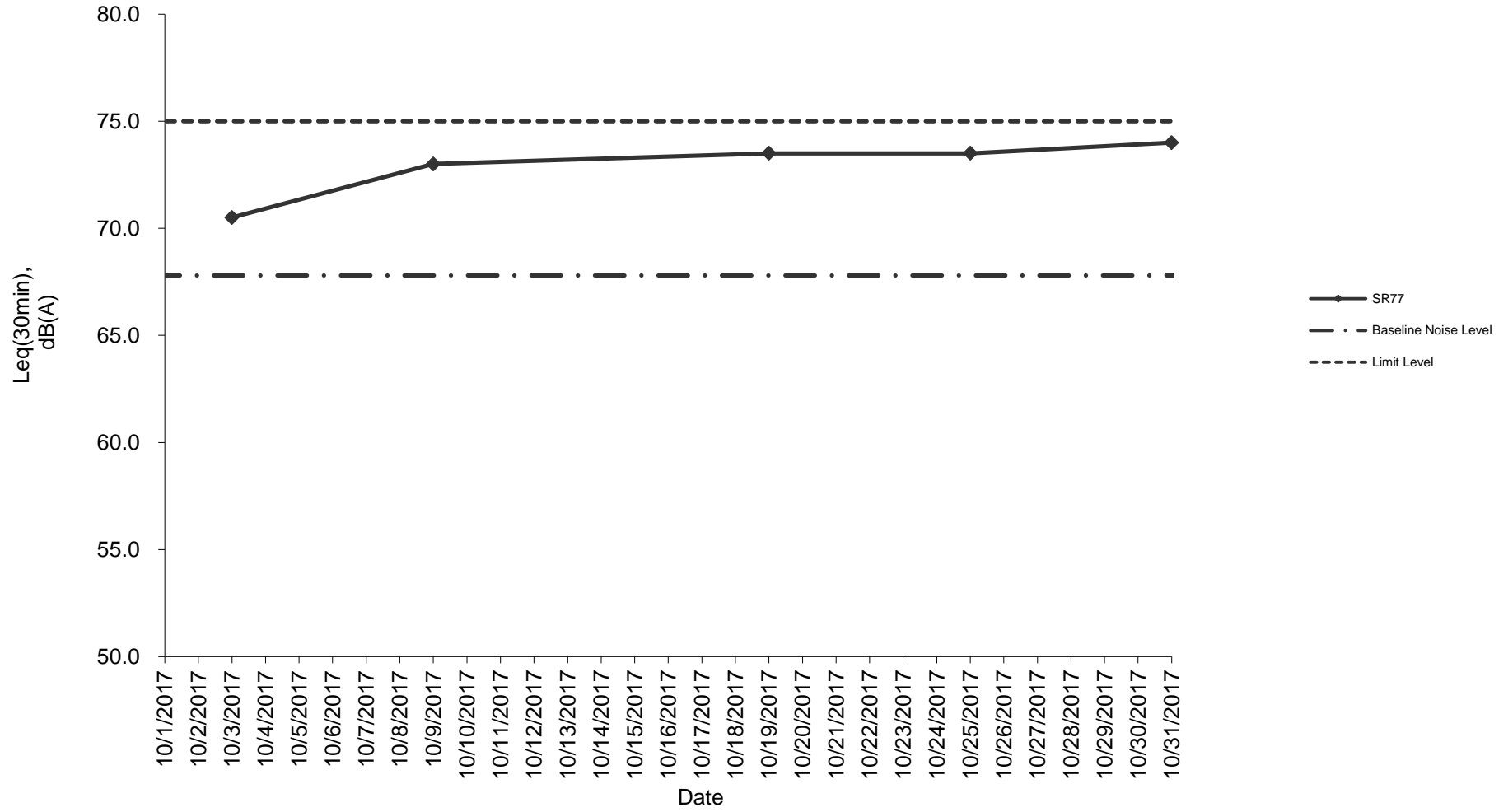

Noise monitoring result: SR77 (July 2017 - October 2017)

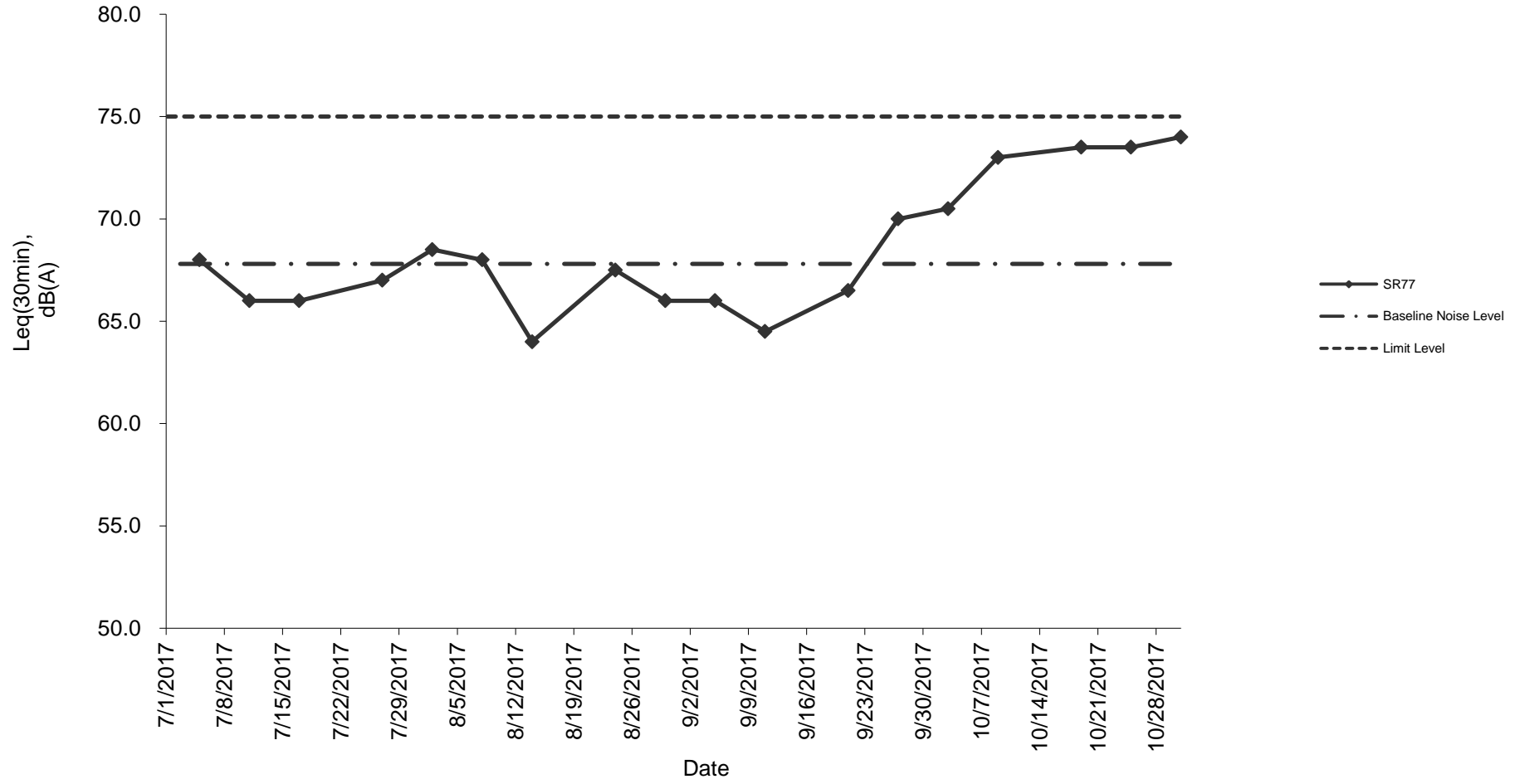

Appendix K Waste Flow Table

Monthly Summary Waste Flow Table

Month	Actual Quantities of Inert C&D Materials Generated Monthly							Actual Quantities of C&D Wastes Generated Monthly				
	Total Quantity Generated	Hard Rock and Large Broken Concrete	Soil	Soil Reused in the Contract	Soil Reused in other Projects	Soil Disposed as Public Fill	Imported Fill	Metals	Paper/ cardboard packaging (Note 3)	Plastics	Chemical Waste	General Refuse (Note 2)
Unit	(in '000m ³)	(in '000m ³)	(in '000m ³)	(in '000m ³)	(in '000m ³)	(in '000m ³)	(in '000m ³)	(in '000m ³)	(in '000m ³)	(in '000m ³)	(in m ³)	(in '000m ³)
Jan-17	1.150	0.204	0.946	0.150	-	0.796	1.150	-	-	0.001	-	0.170
Feb-17	1.160	0.308	0.852	0.192	-	0.660	0.926	-	-	0.001	-	0.140
Mar-17	2.287	0.565	1.722	0.060	-	1.662	1.055	-	-	-	-	0.115
Apr-17	1.003	0.064	0.939	0.036	-	0.903	0.463	-	-	0.004	-	0.075
May-17	0.497	0.005	0.492	0.120	-	0.372	0.050	0.767	-	-	-	0.105
Jun-17	1.248	0.150	1.098	0.150	-	0.948	0.008	-	-	-	-	0.135
Sub-Total	7.345	1.296	6.049	0.708	-	5.341	3.652	0.767	-	0.006	-	0.740
Jul-17	1.917	0.180	1.737	0.120	-	1.617	0.542	-	-	-	-	0.065
Aug-17	1.297	0.118	1.179	0.120	-	1.059	0.099	-	-	-	-	0.130
Sep-17	2.448	0.437	2.011	0.090	-	1.921	0.291	-	-	-	-	0.115
Oct-17	2.156	0.544	1.612	0.240	-	1.372	0.939	-	-	-	-	0.090
Nov-17	-	-	-	-	-	-	-	-	-	-	-	-
Dec-17	-	-	-	-	-	-	-	-	-	-	-	-
Total	15.163	2.575	12.588	1.278	-	11.310	5.523	0.767	-	0.006	-	1.140

- Note:
1. Assume the density of soil fill is 2 ton/m³.
 2. Assume the density of rock and broken concrete is 2.5 ton/m³.
 3. Assume each truck of C&D wastes is 5m³.
 4. The inert C&D materials except slurry and bentonite are disposed at Tuen Mun 38.
 5. The slurry and bentonite are disposed at Tseung Kwun O 137.
 6. The non-inert C&D wastes are disposed at NENT.
 7. Assume the density of metal is 7,850 kg/m³.

Appendix L Implementation Schedule of Environmental Mitigation Measures (EMIS)

Impact	Environmental Protection Measures	Timing	Responsibility	Implementation Status #
Air Quality				
Air Quality during Construction	<ul style="list-style-type: none"> ● Restricting heights from which materials are dropped, as far as practicable to minimize the fugitive dust arising from unloading/loading. ● All stockpiles of excavated materials or spoil of more than 50m³ shall be enclosed, covered or dampened during dry or windy conditions. ● Effective water sprays shall be used to control potential dust emission sources such as unpaved haul roads and active construction areas. ● All spraying of materials and surfaces shall avoid excessive water usage. ● Vehicles that have the potential to create dust while transporting materials shall be covered, with the cover properly secured and extended over the edges of the side and tail boards. ● Materials shall be dampened, if necessary, before transportation. ● Travelling speeds shall be controlled to reduce traffic induced dust dispersion and re-suspension within the site from the operating haul trucks. ● Vehicle washing facilities shall be provided to minimise the quantity of material deposited on public roads. 	During Construction	Contractor	✓ ✓ ✓ ✓ ✓ ✓ ✓ ✓
Air Quality during Operation	Not required	N/A	N/A	N/A
Noise				
Noise during Construction	<ul style="list-style-type: none"> ● Use of silenced plant or plant equipped with mufflers or dampers in substitute of ordinary plant. ● Reduce the number of equipment and their percentage on-time. 	During Construction	Contractor	✓ ✓
Noise during Operation	Not required	N/A	N/A	N/A
Water Quality				
Water Quality during Construction	<u>Road Widening Works, Earthworks and Culvert Extension Works</u> <ul style="list-style-type: none"> ● Wastewater generated from any concrete batching washdown of equipment or similar activities should be discharged into foul sewers, after the removal of settleable solids, and pH adjustment as necessary. All sewage discharges from the study area should meet the TM standards and approval from EPD through the licensing process is required. 	During Construction	Contractor	✓

Notes (#): ✓ – Compliance; Rem – Reminder; Obs – Observation; N/C – Non Compliance; N/A – Not Applicable

Impact	Environmental Protection Measures	Timing	Responsibility	Implementation Status #
	<ul style="list-style-type: none"> ● Sand traps, oil interceptors and other pollution prevention installations should be provided, properly cleaned and maintained. ● Runoff from exposed working areas, unfinished slopes and from unlined temporary channels should be directed to stilling basins and/or silt traps before discharging to the drainage outfalls. ● Regular inspections of stilling basins and/or silt traps is required to ensure that sediment is not conveyed into the existing drainage system. ● Open stockpiles should be covered with a tarpaulin cover. ● During the wet season, any exposed top soils should be covered with a tarpaulin, shotcreted or hydroseeded. ● Sand and silt from wash-water from vehicle washing should be settled out before discharging into storm drains. ● Fuels should be stored in bunded areas such that spillage can be easily collected. 			<ul style="list-style-type: none"> ✓ ✓ ✓ ✓ ✓ ✓ ✓
Water Quality during Operation	Not required	N/A	N/A	N/A
Waste Management				
Waste Management during Construction	<p><u>General Waste</u></p> <ul style="list-style-type: none"> ● Transport of wastes off site as soon as possible. ● Maintenance of accurate waste records. ● Minimisation of waste generation for disposal (via reduction/recycling/re-use). ● No on-site burning will be permitted. ● Use of re-useable metal hoardings/signboards. <p><u>Vegetation from site clearance</u></p> <ul style="list-style-type: none"> ● Segregation of materials to facilitate disposal. ● Mulching to reduce bulk and where possible review opportunities for the possible beneficial use within landscaping areas. 	<p>During Construction</p> <p>During Construction</p>	<p>Contractor</p> <p>Contractor</p>	<p>Rem✓</p> <ul style="list-style-type: none"> ✓ ✓ ✓ ✓ ✓ ✓

Notes (#): ✓ – Compliance; Rem – Reminder; Obs – Observation; N/C – Non Compliance; N/A – Not Applicable

Impact	Environmental Protection Measures	Timing	Responsibility	Implementation Status #
	<p><u>Demolition Wastes</u></p> <ul style="list-style-type: none"> • Segregation of materials to facilitate disposal. • Appropriate stockpile management. <p><u>Excavated Materials</u></p> <ul style="list-style-type: none"> • Segregation of materials to facilitate disposal / reuse. • Appropriate stockpile management. • Re-use of excavated material on or off site (where possible). • Special handling and disposal procedures in the event that contaminated materials are excavated. <p><u>Construction Wastes</u></p> <ul style="list-style-type: none"> • Segregation of materials to facilitate recycling/reuse (within designated area in appropriate containers/stockpiles). • Appropriate stockpile management. • Planning to reduce over ordering and waste generation. • Recycling and re-use of materials where possible (e.g. metal, wood from formwork) • For material which cannot be re-used/recycled, collection should be carried out by an approved waste contractor for landfill disposal. <p><u>Bentonite Slurries</u></p> <ul style="list-style-type: none"> • Bentonite slurries should be reused as far as possible. • Disposal in accordance with Practice Note For Professional Persons ProPECC PN 1/94. <p><u>Chemical Wastes</u></p> <ul style="list-style-type: none"> • Storage within locked, covered and bunded area. • The storage area shall not be located adjacent to sensitive receivers e.g. drains. • Minimise waste production and recycle oils/solvents where possible. 	<p>During Construction</p> <p>During Construction</p> <p>During Construction</p> <p>During Construction</p>	<p>Contractor</p> <p>Contractor</p> <p>Contractor</p> <p>Contractor</p>	<p>✓</p> <p>✓</p> <p>✓</p> <p>✓</p> <p>✓</p> <p>N/A</p> <p>✓</p> <p>✓</p> <p>✓</p> <p>✓</p> <p>✓</p> <p>✓</p> <p>N/A</p> <p>N/A</p> <p>✓</p> <p>✓</p> <p>✓</p>

Notes (#): ✓ – Compliance; Rem – Reminder; Obs – Observation; N/C – Non Compliance; N/A – Not Applicable

Impact	Environmental Protection Measures	Timing	Responsibility	Implementation Status #
	<ul style="list-style-type: none"> ● A spill response procedure shall be in place and absorption material available for minor spillages. ● Use appropriate and labelled containers. ● Educate site workers on site cleanliness/waste management procedures. ● If chemical wastes are to be generated, the contractor must register with EPD as a chemical waste producer. ● The chemical wastes shall be collected by a licensed chemical waste collector. <p><u>Municipal Wastes</u></p> <ul style="list-style-type: none"> ● Waste shall be stored within a temporary refuse collection facility, in appropriate containers prior to collection and disposal. ● Regular, daily collections are required by an approved waste collector. 	During Construction	Contractor	<ul style="list-style-type: none"> ✓ ✓ ✓ ✓ ✓ ✓ ✓
Waste Management during Operation	Not required.	N/A	N/A	N/A
Ecology				
Ecology during Construction	<p><u>Accurate Delineation of Works Area</u></p> <ul style="list-style-type: none"> ● Boundaries of proposed works areas shall be clearly identified and separated from external areas by a physical barrier to prevent encroachment of adjacent habitats. ● Individual trees which fall within the works areas but which work plans show do not require removal are to be retained and fenced off to maximise protection. <p><u>Dust generation</u></p> <p>There are a number of measures which shall be taken as specified in the Air Pollution Control (Construction Dust) Regulation on 'Dust Control Requirements, including the following key measures to be applied during construction:</p> <ul style="list-style-type: none"> ● vehicle washing facilities to be provided at every discernible or designated vehicle exit point; 	During Construction	Contractor	<ul style="list-style-type: none"> ✓ ✓ ✓

Notes (#): ✓ – Compliance; Rem – Reminder; Obs – Observation; N/C – Non Compliance; N/A – Not Applicable

Impact	Environmental Protection Measures	Timing	Responsibility	Implementation Status #
	<ul style="list-style-type: none"> ● all temporary site access roads shall be sprayed with water to suppress dust as necessary; ● all dusty materials should be sprayed with water immediately prior to any handling; and ● all debris should be covered entirely by impervious sheeting or stored in a sheltered debris collection area. <p><u>Surface Run-off</u></p> <p>In general, mitigation measures shall be in accordance with ProPECC PN1/94 on 'Construction Site Drainage'. Key measures include:</p> <ul style="list-style-type: none"> ● Bund and cover stockpiles to avoid run-off; ● Channel any run-off through a system of oil, grease and sediment / silt traps and reuse water on site where ever practical; ● All vehicle maintenance to be undertaken within a bunded area; and ● Maximise vegetation retention on-site to maximise absorption (minimise transport). 	During Construction	Contractor	✓ ✓ ✓ ✓ ✓ ✓
Ecology during Operation	<ul style="list-style-type: none"> ● To conduct compensatory ecological planting as specified in the latest landscape plans approved by EPD (Clause 2.6 of the Environmental Permit refers). 	During Construction and operation	Contractor (during construction) / LCSD* (during operation) (Note: * The division of vegetation planting and maintenance responsibilities shall follow the guidelines stipulated in ETWB TCW No. 2/2004.)	N/A
Landscape and Visual				
Landscape and Visual during Construction	<p><u>Preservation of Existing Vegetation</u></p> <ul style="list-style-type: none"> ● Trees identified for retention within the project limit would be protected during the works ● The tree transplanting and planting works shall be implemented by approved Landscape Contractors 	During Construction	Contractor	✓ ✓

Notes (#): ✓ – Compliance; Rem – Reminder; Obs – Observation; N/C – Non Compliance; N/A – Not Applicable

Impact	Environmental Protection Measures	Timing	Responsibility	Implementation Status #
	<p><u>Temporary Works Areas</u> Where feasible the works areas would be screened using hoarding and existing vegetation would be retained where possible to reduce the landscape and visual impacts arising from the construction activity. The landscape of these works areas would be restored following the completion of the construction phase.</p> <p><u>Hoarding</u> A hoarding would be erected where practicable in the most visually sensitive locations to screen the temporary construction works from the local VSRs.</p> <p><u>Top Soils</u> The works will result in disturbance to extensive areas of topsoil. Topsoil worthy of retention should be stockpiled for use following completion of the civil engineering works. It should either be temporarily vegetated with hydroseeded grass or turned over on a regular basis.</p> <p><u>Protection of Important Landscape Features</u> Important features such as temples, Island House and kilns within the study area, although remote from the proposed works retained and adequately protected.</p>	During Construction	Contractor	✓
		During Construction	Contractor	✓
		During Construction	Contractor	N/A
		During Construction	Contractor	N/A
Landscape and Visual during Operation	Not required.	N/A	N/A	N/A

Notes (#): ✓ – Compliance; Rem – Reminder; Obs – Observation; N/C – Non Compliance; N/A – Not Applicable

Appendix N

Cumulative Statistics on Complaints, Notifications of Summons and Successful Prosecutions

Cumulative Complaint Log

Complaint Log No.	Date of Complaint	Received From and Received By	Location of Complainant	Nature of Complaint	Outcome	Status
C131126	26, November, 2013	Mr. Tony Hung from WWF	Mat Wat River (works sites for box culvert extension)	Suspected unauthorised discharge of water from a construction site to Ma Wat River, Tai Wo Service Road East, Tai Po	<p>It was found that the water leaving the end of the steel pipes was the diverted water from the upstream of the existing box culverts, instead of being discharged from the construction works sites.</p> <p>An EM&A Programme is being undertaken to monitoring the environmental performance of the construction works, and the Contractor has also implemented appropriate mitigation measures to avoid silt-laden runoff discharging from the works sites into the river.</p> <p>The complaint is considered an invalid complaint under this Project.</p>	Completed

Complaint Log No.	Date of Complaint	Received From and Received By	Location of Complainant	Nature of Complaint	Outcome	Status
C141120	20 November, 2014	EPD	Ng Tung River and Ma Wat River nearby the site of the Liantang/ Heung Yuen Wai BCP Project (Contract Number CV/2012/09)	At Bridge NF426 in Fanling, the whole Ng Tung River showed milky and suspected illegal discharge by nearby factory has undertaken. (粉嶺近天橋編號 NF426 梧桐河整條河河水呈奶白色懷疑附近有工廠非法排放污水)	<p>Water Supplies Department (WSD) conducted a washout procedure on 20 November 2014 at about 9:30am to flush the newly installed water pipe of diameter of 1400mm which has recently finished disinfection. It is understood that the procedure has lasted for about 1 hour and large amount of freshwater has been discharged into the Ma Wat River through a washout port.</p> <p>Although water was observed seeping from the gantry switch and flew into the works sites, the area is a sump pit and the water was unlikely to run off and entered the river directly. As such, it is anticipated that only freshwater has been discharged into Ma Wat River through the washout port.</p> <p>Both site inspections conducted by the ET before the complaint (19 November 2014), and after the complaint (24 November 2014) did not identify any deficiencies on environmental mitigation measures. Also, there were no rains during the period and the risk of construction site run-off is considered minimal.</p>	Completed

Complaint Log No.	Date of Complaint	Received From and Received By	Location of Complainant	Nature of Complaint	Outcome	Status
					<p>The water from the Ma Wat Channel adjoins the Ng Tung River before passing through the complaint location, so other pollution sources may also occur at upstream of Ng Tung River</p> <p>The complaint is considered unlikely due to the construction works of this project.</p>	



**Meinhardt Infrastructure and
Environment Ltd**
邁進基建環保工程顧問有限公司

10/F Genesis
33-35 Wong Chuk Hang Road
Hong Kong
香港黃竹坑道33-35號
創協坊10樓

Tel 電話: +852 2858 0738
Fax 傳真: +852 2540 1580

mail@meinhardt.com.hk
www.meinhardt-china.com
www.meinhardtgroup.com